



# BRAKE DISC

## 08.7811.10

The **08.7811.10** brake disc is synonymous with reliability

The Brembo brake disc is fully interchangeable with an Original Equipment brake disc. The control of the entire production cycle allows Brembo to offer brake discs with outstanding performance levels, reliability, durability and comfort in all conditions of use. All Brembo brake discs are accompanied by the ECE-R90 homologation.

- ✓ OE-equivalent
- ✓ Brembo quality
- ✓ ECE-R90 certificate
- ✓ Safety



### Technical specifications

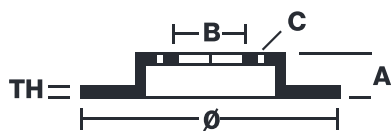

EAN code  
**8020584781111**

Axle  
**Front**

Diameter Ø  
**230** mm

Thickness (TH)  
**11** mm

Height (A)  
**44** mm

Number of holes (C)  
**4**

Brake disc type  
**Solid**

Centering (B)  
**67** mm

Min. thickness  
**9,4** mm

Tightening torque  
**100** Nm

<b>08.7811.10</b>	
AP	15381
BRECO	BS 7588
DIMENSION	230 x 11 mm
MIN TH	9,4 mm
BALANCING	GUARANTEED
MATERIAL	SUB-GROUP 1
WEIGHT	3,2 kg
E11	90R 02C01202/25289

DATE : 11/04/2016 VERSION : 01

**COMPATIBLE VEHICLES**

### COMPATIBLE OE PART NUMBERS

5171202000	HYUNDAI
5171202100	HYUNDAI