



BRAKE DISC

08.4423.20

The **08.4423.20** brake disc is synonymous with reliability

The Brembo brake disc is fully interchangeable with an Original Equipment brake disc. The control of the entire production cycle allows Brembo to offer brake discs with outstanding performance levels, reliability, durability and comfort in all conditions of use. All Brembo brake discs are accompanied by the ECE-R90 homologation.

- ✓ OE-equivalent
- ✓ Brembo quality
- ✓ ECE-R90 certificate
- ✓ Safety
- ✓ Fastening screws



Technical specifications

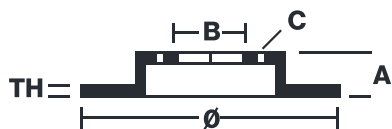

EAN code	Axle	Diameter Ø
8020584442326	Front	231 mm
Thickness (TH)	Height (A)	Number of holes (C)
12 mm	50 mm	4
Brake disc type	Centering (B)	Min. thickness
Solid	61 mm	10 mm

COMPATIBLE VEHICLES

COMPATIBLE OE PART NUMBERS

45251692000	HONDA
-------------	-------

45251692003	HONDA
-------------	-------

45251SA0660	HONDA
-------------	-------

45251SA5000	HONDA
-------------	-------

45251SA5010	HONDA
-------------	-------
