



BRAKE DISC

08.3712.10

The 08.3712.10 brake disc is synonymous with reliability

The Brembo brake disc is fully interchangeable with an Original Equipment brake disc. The control of the entire production cycle allows Brembo to offer brake discs with outstanding performance levels, reliability, durability and comfort in all conditions of use. All Brembo brake discs are accompanied by the ECE-R90 homologation.

- ✓ OE-equivalent
- ✓ Brembo quality
- ✓ ECE-R90 certificate
- ✓ Safety
- ✓ Fastening screws



Technical specifications

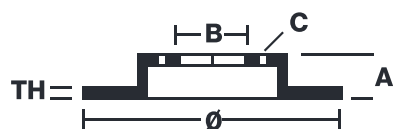

EAN code	Axle	Diameter Ø
8020584371213	Front	280 mm
Thickness (TH)	Height (A)	Number of holes (C)
12,7 mm	78 mm	5
Brake disc type	Centering (B)	Min. thickness
Solid	74 mm	11,1 mm

COMPATIBLE VEHICLES

COMPATIBLE OE PART NUMBERS

34111116947	BMW
34111152295	BMW
34111156124	BMW
34111156128	BMW
34111163144	BMW