



# BRAKE DISC

## 09.5088.10

The **09.5088.10** brake disc is synonymous with reliability

The Brembo brake disc is fully interchangeable with an Original Equipment brake disc. The control of the entire production cycle allows Brembo to offer brake discs with outstanding performance levels, reliability, durability and comfort in all conditions of use. All Brembo brake discs are accompanied by the ECE-R90 homologation.

- ✓ OE-equivalent
- ✓ Brembo quality
- ✓ ECE-R90 certificate
- ✓ Safety



### Technical specifications

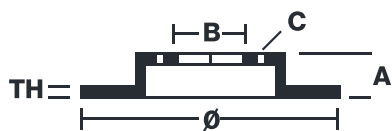

EAN code  
**8020584508817**

Axle  
**Front**

Diameter Ø  
**242 mm**

Thickness (TH)  
**18 mm**

Height (A)  
**44 mm**

Number of holes (C)  
**4**

Brake disc type  
**Ventilated**

Centering (B)  
**70 mm**

Min. thickness  
**16 mm**

Tightening torque  
**85 Nm**

<b>09.5088.10</b>	
AP	24211
BRECO	BS 7953
DIMENSION	242 x 18 mm
MIN TH	16 mm
BALANCING	GUARANTEED
MATERIAL	SUB-GROUP 1
WEIGHT	4.2 kg
E11	90R 02C01202/25623

**COMPATIBLE VEHICLES**

## COMPATIBLE OE PART NUMBERS

25431GA170	SUBARU
25431GA171	SUBARU
25431GA200	SUBARU