



BRAKE DISC

09.8656.10

The **09.8656.10** brake disc is synonymous with reliability

The Brembo brake disc is fully interchangeable with an Original Equipment brake disc. The control of the entire production cycle allows Brembo to offer brake discs with outstanding performance levels, reliability, durability and comfort in all conditions of use. All Brembo brake discs are accompanied by the ECE-R90 homologation.

- ✓ OE-equivalent
- ✓ Brembo quality
- ✓ ECE-R90 certificate
- ✓ Safety



Technical specifications

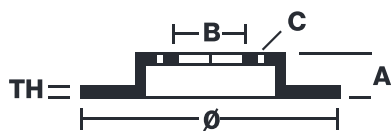

EAN code
8020584865613

Axle
Front

Diameter Ø
243 mm

Thickness (TH)
20 mm

Height (A)
44 mm

Number of holes (C)
4

Brake disc type
Ventilated

Centering (B)
57 mm

Min. thickness
18 mm

Tightening torque
100 Nm

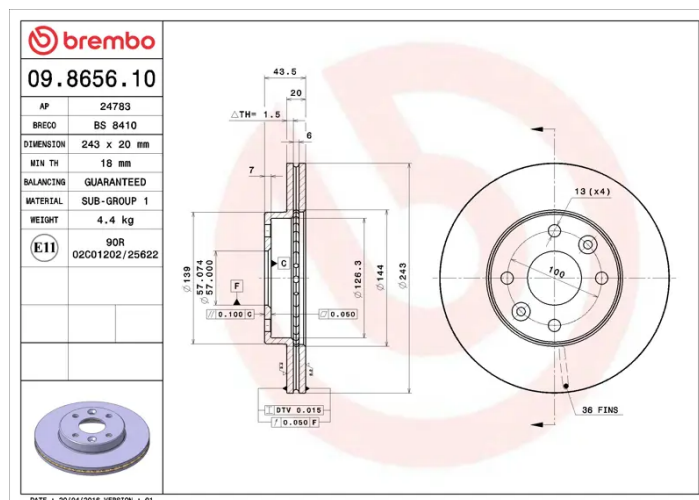

COMPATIBLE VEHICLES

COMPATIBLE OE PART NUMBERS

0K0AA33251	KIA
------------	-----

0K20A33251	KIA
------------	-----

0K20A33251A	KIA
-------------	-----

0K20A33251B	KIA
-------------	-----

0K2AA33251	KIA
------------	-----

0K2AA33251A	KIA
-------------	-----

0K2AA33251B	KIA
-------------	-----

0K2AA33251C	KIA
-------------	-----

0K2AZ33251	KIA
------------	-----

K20A33251	KIA
-----------	-----

K20A33251A	KIA
------------	-----

K2AA33251A	KIA
------------	-----

K2AA33251B	KIA
------------	-----

0K2AA33251A	TIMOR
-------------	-------

0K2AA33251B	TIMOR
-------------	-------

0K2AA33251C	TIMOR
-------------	-------

0K2AA33251DS	TIMOR
--------------	-------