



DRUM

14.A686.10

The **14.A686.10** drum is synonymous with reliability

Brembo has developed several design solutions for drum brakes which combine multiple materials to reduce the overall weight. The most popular range of lamellar graphite cast iron drums is supplemented by cast iron drums with a steel sprocket flange and aluminium drums, whereby only the inner part of the drum on which the shoes operate are made of lamellar cast iron, namely the brake band. Additionally drums with built-in bearing kit and hub are added to this range.



- ✓ OE-equivalent
- ✓ Brembo quality
- ✓ Safety
- ✓ Durability

Technical specifications

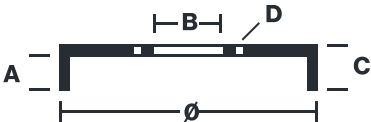

EAN code	Axle	Diameter
8020584023075	Rear	228 mm
Width	Height	Number of holes
43,5 mm	63	5
Centering	Max diameter	
58 mm	230 mm	

		14.A686.10	
AP	55330		
SRECO	BT 1686		
DIMENSION	228.7 x 43.5 mm		
MAX DIA	230 mm		
BALANCING	GUARANTEED		
MATERIAL	SUB-GROUP 1		
WEIGHT	4.6 kg		
	90R		
	02D01202/59685		

COMPATIBLE VEHICLES

COMPATIBLE OE PART NUMBERS

26340AA010 SUBARU