



# BRAKE DISC

## 09.6925.10

**The 09.6925.10 brake disc is synonymous with reliability**

The Brembo brake disc is fully interchangeable with an Original Equipment brake disc. The control of the entire production cycle allows Brembo to offer brake discs with outstanding performance levels, reliability, durability and comfort in all conditions of use. All Brembo brake discs are accompanied by the ECE-R90 homologation.

- ✓ OE-equivalent
- ✓ Brembo quality
- ✓ ECE-R90 certificate
- ✓ Safety
- ✓ Fastening screws

### Technical specifications

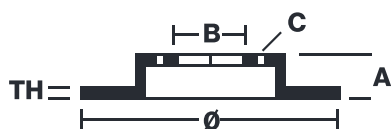

EAN code	Axle	Diameter Ø
-	Front	283 mm
Thickness (TH)	Height (A)	Number of holes (C)
26 mm	28 mm	4
Brake disc type	Centering (B)	Min. thickness
Ventilated	66 mm	24 mm
Tightening torque		
90 Nm		

COMPATIBLE VEHICLES

## COMPATIBLE OE PART NUMBERS