



BRAKE DISC

08.4496.10

The **08.4496.10** brake disc is synonymous with reliability

The Brembo brake disc is fully interchangeable with an Original Equipment brake disc. The control of the entire production cycle allows Brembo to offer brake discs with outstanding performance levels, reliability, durability and comfort in all conditions of use. All Brembo brake discs are accompanied by the ECE-R90 homologation.

- ✓ OE-equivalent
- ✓ Brembo quality
- ✓ ECE-R90 certificate
- ✓ Safety



Technical specifications

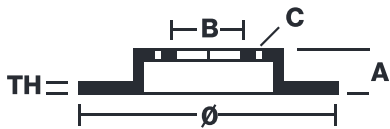

EAN code	Axle	Diameter Ø
8020584449615	Front	255 mm
Thickness (TH)	Height (A)	Number of holes (C)
12,5 mm	27 mm	4
Brake disc type	Centering (B)	Min. thickness
Solid	80 mm	11 mm

COMPATIBLE VEHICLES

COMPATIBLE OE PART NUMBERS

MB081630	DODGE
MB081630	MITSUBISHI
MB081630	PLYMOUTH