



BRAKE DISC

08.1980.10

The **08.1980.10** brake disc is synonymous with reliability

The Brembo brake disc is fully interchangeable with an Original Equipment brake disc. The control of the entire production cycle allows Brembo to offer brake discs with outstanding performance levels, reliability, durability and comfort in all conditions of use. All Brembo brake discs are accompanied by the ECE-R90 homologation.

- ✓ OE-equivalent
- ✓ Brembo quality
- ✓ ECE-R90 certificate
- ✓ Safety

Technical specifications

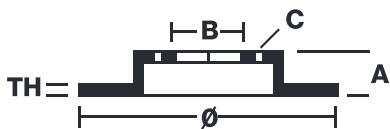

EAN code	Axle	Diameter Ø
8020584198018	Front	213 mm
Thickness (TH)	Height (A)	Number of holes (C)
11 mm	61 mm	4
Brake disc type	Centering (B)	Min. thickness
Solid	56 mm	10,2 mm

COMPATIBLE VEHICLES

COMPATIBLE OE PART NUMBERS

BTA926	AUSTIN
--------	--------

BTA926	MG
--------	----

BTA926	MORRIS
--------	--------

BTA926	RILEY
--------	-------

BTA926	WOLSELEY
--------	----------