

## Technische Daten der Scheiben

<b>Achse</b> Hinten	<b>Durchmesser</b> 262 mm
<b>Gesamthöhe</b> (A) 61,1 mm	<b>Nabendurchmesser</b> (B) 76 mm
<b>Anzahl der Bohrungen</b> (C) 5	<b>Stärke</b> (TH) 10 mm
<b>Minimalstärke</b> 8,4 mm	<b>Anzugsmoment</b> 100 Nm
<b>Stück pro Karton</b> 2	<b>EAN-Code</b> 8020584210420

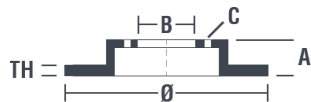

## Herstellernummer

**Brembo**  
08.A869.11

**AP**  
14986 V

**Breco**  
BV 7777

<b>08.A869.10</b>	
AP	14986 V-14986
BRECO	BV 7777-BS 7777
DIMENSION	262 x 10 mm
MIN TH	8,4 mm
MAX DIA	182 mm
BALANCING	GUARANTEED
MATERIAL	SUB-GROUP 1
WEIGHT	3,9 kg
	INSIDE THE BOX 205.5886.21
	08.A869.11
DATE : 21/11/2014 VERSION : 01	

## Technische Daten

### Scheibe mit Befestigungsschraube

Die der Verpackung beigelegte Befestigungsschraube erleichtert Mechanikern die Arbeit, insbesondere bei verrostetem oder verschlissenen Originalteil.



### UV-Scheibe

Die UV-Lack-Beschichtung gewährleistet überlegenen Korrosionsschutz und umfassenden Schutz der Scheibe.



## Kompat. Fahrzg.

### HYUNDAI

Modell	Typ	KW	Baujahr
i30 (FD)	1.4	77	10/07 11/11
i30 (FD)	1.4	80	10/07 11/11
i30 (FD)	1.6	93	02/08 11/11
i30 (FD)	1.6	85	10/07 11/11
i30 (FD)	1.6	90	10/07 11/11
i30 (FD)	1.6 CRDi	94	01/10 11/11

i30 (FD)	1.6 CRDi	66	10/07 11/11
i30 (FD)	1.6 CRDi	85	10/07 11/11
i30 (FD)	2.0	105	10/07 11/11
i30 (FD)	2.0 CRDi	100	10/07 11/11
i30 (FD)	2.0 CRDi	103	10/07 11/11
i30 Estate (FD)	1.4	77	10/07 06/12
i30 Estate (FD)	1.4	80	11/09 06/12
i30 Estate (FD)	1.6	85	02/08 06/12
i30 Estate (FD)	1.6	90	02/08 06/12
i30 Estate (FD)	1.6	93	02/08 06/12
i30 Estate (FD)	1.6 CRDi	94	01/10 06/12
i30 Estate (FD)	1.6 CRDi	66	02/08 06/12
i30 Estate (FD)	1.6 CRDi	85	02/08 06/12
i30 Estate (FD)	2.0	105	02/08 06/12
i30 Estate (FD)	2.0 CRDi	103	02/08 06/12
i30 Estate (FD)	2.0 CRDi	100	10/08 06/12
ix35 (LM, EL, ELH)	1.6	99	11/10 -
ix35 (LM, EL, ELH)	1.7 CRDi	85	11/10 -
ix35 (LM, EL, ELH)	2.0	120	01/10 -
ix35 (LM, EL, ELH)	2.0 CRDi	100	01/10 -
ix35 (LM, EL, ELH)	2.0 CRDi	130	01/12 -
ix35 (LM, EL, ELH)	2.0 CRDi	135	01/12 -
ix35 (LM, EL, ELH)	2.0 CVVT	110	08/09 -

## HYUNDAI (BEIJING)

Modell	Typ	kW	Baujahr
i30 Hatchback	1.6	90	07/09 12/14
i30 Hatchback	2.0	105	07/09 12/14
ix25	1.6	92	10/14 -
ix25	1.6 TGDI	118	09/16 -
ix25	2.0	118	10/14 12/17
ix25	2.0 AWD	118	10/14 12/17
ix35	2.0	120	04/10 12/12
ix35	2.0	118	04/12 -
ix35	2.0	121	04/12 -

ix35	2.4	128	04/10 12/17
ix35	2.4	125	04/12 -
<b>KIA</b>			
Modell	Typ	kW	Baujahr
CEE'D Hatchback (ED)	1.4	77	12/06 12/12
CEE'D Hatchback (ED)	1.4	80	12/06 12/12
CEE'D Hatchback (ED)	1.4 CVVT	66	08/09 12/12
CEE'D Hatchback (ED)	1.6	93	02/08 12/12
CEE'D Hatchback (ED)	1.6	85	09/07 12/12
CEE'D Hatchback (ED)	1.6	90	12/06 12/12
CEE'D Hatchback (ED)	1.6 CRDi 115	85	12/06 12/12
CEE'D Hatchback (ED)	1.6 CRDi 128	94	10/10 12/12
CEE'D Hatchback (ED)	1.6 CRDi 90	66	12/06 12/12
CEE'D Hatchback (ED)	1.6 CVVT	92	10/10 12/12
CEE'D Hatchback (ED)	2.0	105	12/06 12/12
CEE'D Hatchback (ED)	2.0 CRDi	100	06/07 12/12
CEE'D Hatchback (ED)	2.0 CRDi 140	103	09/07 12/12
CEE'D SW (ED)	1.4	80	09/07 12/12
CEE'D SW (ED)	1.4	77	10/10 12/12
CEE'D SW (ED)	1.4 CVVT	66	07/09 12/12
CEE'D SW (ED)	1.6	85	09/07 11/12
CEE'D SW (ED)	1.6	90	09/07 12/12
CEE'D SW (ED)	1.6	93	09/07 12/12
CEE'D SW (ED)	1.6 CRDi 115	85	09/07 12/12
CEE'D SW (ED)	1.6 CRDi 128	94	10/10 12/12
CEE'D SW (ED)	1.6 CRDi 90	66	09/07 12/12
CEE'D SW (ED)	1.6 CVVT	92	06/09 12/12
CEE'D SW (ED)	1.6 LPG	91	01/08 09/12
CEE'D SW (ED)	2.0	105	09/07 12/12
CEE'D SW (ED)	2.0 CRDi 140	103	07/07 12/12
PRO CEE'D (ED)	1.4	77	02/08 09/12
PRO CEE'D (ED)	1.4	80	02/08 09/12
PRO CEE'D (ED)	1.4 CVVT	66	06/10 09/12
PRO CEE'D (ED)	1.6	90	02/08 09/12

PRO CEE'D (ED)	1.6	93	02/08 09/12
PRO CEE'D (ED)	1.6 CRDi 115	85	02/08 09/12
PRO CEE'D (ED)	1.6 CRDi 128	94	10/10 09/12
PRO CEE'D (ED)	1.6 CRDi 90	66	02/08 09/12
PRO CEE'D (ED)	1.6 CVVT	92	10/10 02/13
PRO CEE'D (ED)	2.0	105	02/08 09/12
PRO CEE'D (ED)	2.0 CRDi 140	103	02/08 09/12
PRO CEE'D (ED)	2.0 LPG	105	01/09 12/09
SPORTAGE (SL)	1.6 GDI	99	02/11 -
SPORTAGE (SL)	1.7 CRDi	85	12/10 -
SPORTAGE (SL)	2.0 CRDi	100	07/10 -
SPORTAGE (SL)	2.0 CRDi	135	08/10 -
SPORTAGE (SL)	2.0 CVVT	110	06/10 12/13
SPORTAGE (SL)	2.0 CVVT	120	07/10 -
SPORTAGE (SL)	2.0 CVVT	122	07/10 -
SPORTAGE (SL)	2.0 CVVT AWD	120	07/10 -
SPORTAGE (SL)	2.0 CVVT AWD	122	07/10 -
SPORTAGE (SL)	2.0 GDI	122	02/14 -

### KIA (DYK)

Modell	Typ	kW	Baujahr
SPORTAGE-R Closed Off-Road Vehicle	2.0	120	10/10 12/11
SPORTAGE-R Closed Off-Road Vehicle	2.0	121	11/11 -
SPORTAGE-R Closed Off-Road Vehicle	2.0 4WD	120	10/10 12/11
SPORTAGE-R Closed Off-Road Vehicle	2.0 4WD	121	11/11 -
SPORTAGE-R Closed Off-Road Vehicle	2.4 4WD	128	10/10 -

### OE-Teilnr.

#### Passende OE-Teilenummern

HYUNDAI	584111H100
HYUNDAI	584111H300
KIA	584111H100
KIA	584111H300