



BRAKE DISC

08.B351.10

The 08.B351.10 brake disc is synonymous with reliability

The Brembo brake disc is fully interchangeable with an Original Equipment brake disc. The control of the entire production cycle allows Brembo to offer brake discs with outstanding performance levels, reliability, durability and comfort in all conditions of use. All Brembo brake discs are accompanied by the ECE-R90 homologation.



- ✓ OE-equivalent
- ✓ Brembo quality
- ✓ ECE-R90 certificate
- ✓ Safety
- ✓ Fastening screws

Technical specifications

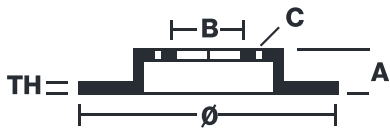

EAN code
8020584028438

Axle
Rear

Diameter Ø
292 mm

Thickness (TH)
12 mm

Height (A)
45 mm

Number of holes (C)
5

Brake disc type
Solid

Centering (B)
71 mm

Min. thickness
10 mm

Tightening torque
110 Nm

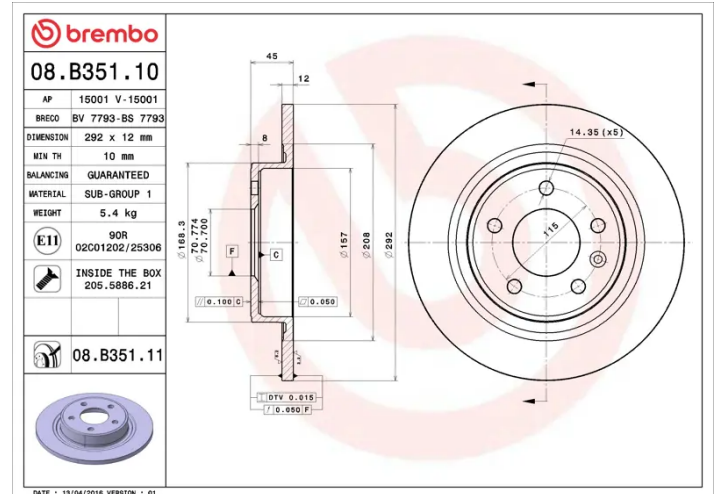

COMPATIBLE VEHICLES

COMPATIBLE OE PART NUMBERS

13502138	BUICK (SGM)
13502139	CHEVROLET
13504280	CHEVROLET
23118061	CHEVROLET
23118282	CHEVROLET
13502138	CHEVROLET (SGM)
0569071	OPEL
0569075	OPEL
0569085	OPEL
0569099	OPEL
13502137	OPEL
13502138	OPEL
13504280	OPEL
23118061	OPEL
569071	OPEL
569075	OPEL
569085	OPEL
569099	OPEL
95527033	OPEL
13502137	VAUXHALL
13502138	VAUXHALL
13504280	VAUXHALL
23118061	VAUXHALL
95527033	VAUXHALL