



BRAKE DISC

09.A352.10

The 09.A352.10 brake disc is synonymous with reliability

The Brembo brake disc is fully interchangeable with an Original Equipment brake disc. The control of the entire production cycle allows Brembo to offer brake discs with outstanding performance levels, reliability, durability and comfort in all conditions of use. All Brembo brake discs are accompanied by the ECE-R90 homologation.



- ✓ OE-equivalent
- ✓ Brembo quality
- ✓ ECE-R90 certificate
- ✓ Safety

Technical specifications

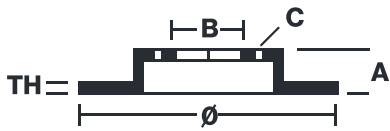

EAN code
8020584016503

Axle
Front

Diameter Ø
257 mm

Thickness (TH)
24,5 mm

Height (A)
48 mm

Number of holes (C)

4

Brake disc type
Ventilated

Centering (B)
69 mm

Min. thickness
22,4 mm

Tightening torque
100 Nm

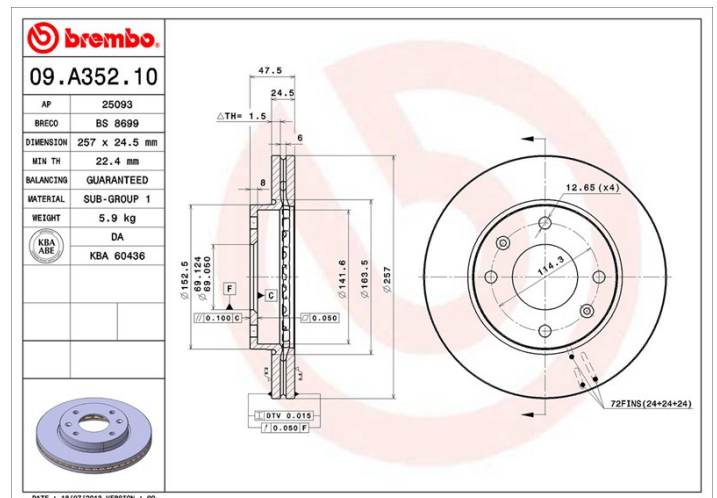

COMPATIBLE VEHICLES

COMPATIBLE OE PART NUMBERS

5171238300	HYUNDAI
51712383A0	HYUNDAI
5171238300	KIA