



**BRAKE DISC**  
**09.9468.20**

**The 09.9468.20 brake disc is synonymous with reliability**

The Brembo brake disc is fully interchangeable with an Original Equipment brake disc. The control of the entire production cycle allows Brembo to offer brake discs with outstanding performance levels, reliability, durability and comfort in all conditions of use. All Brembo brake discs are accompanied by the ECE-R90 homologation.



- ✓ OE-equivalent
- ✓ Brembo quality
- ✓ ECE-R90 certificate
- ✓ Safety
- ✓ High carbon

## Technical specifications

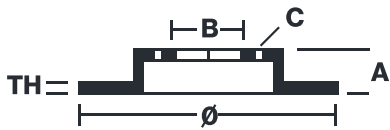

EAN code  
**8020584946824**

Axle  
**Front**

Diameter Ø  
**300** mm

Thickness (TH)  
**25** mm

Height (A)  
**49** mm

Number of holes (C)  
5

Brake disc type  
**Ventilated**

Centering (B)  
**72** mm

Min. thickness  
**23** mm

Tightening torque  
**103** Nm

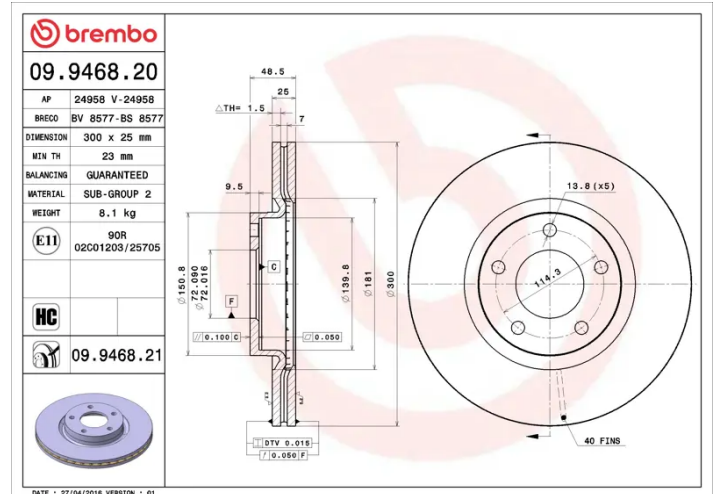

## COMPATIBLE VEHICLES

# COMPATIBLE OE PART NUMBERS

BP6Y3325XD	MAZDA
BP6Y3325XE	MAZDA
BP6Y3325XF	MAZDA
C26Y3325X	MAZDA
C26Y3325XA	MAZDA
C26Y3325XB	MAZDA
C26Y3325XC	MAZDA
C26Y3325XD	MAZDA