

Disc technical data

Axle Front	Diameter 275 mm
Overall height (A) 49,5 mm	Centring diameter (B) 55 mm
Number of holes (C) 5	Thickness (TH) 28 mm
Minimum thickness 26 mm	Tightening torque 103 Nm
Unit per box 2	EANCode 8020584670811

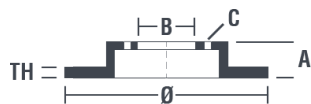

Brand part numbers

Brembo
09.6708.10

AP
24555

Breco
BS 8179

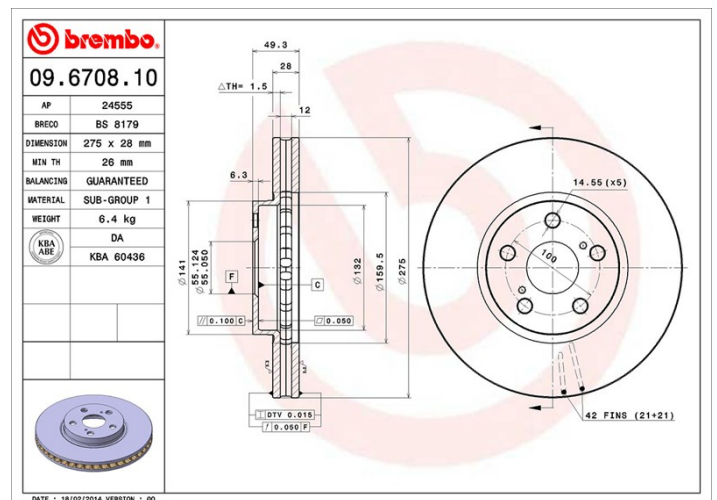

Technical specifications

Compatible vehicles

TOYOTA

Model	Type	Kw	Year
AVENSIS (_T22_)	1.6 VVT-i (ZZT220_)	81	10/00 02/03
AVENSIS (_T22_)	1.8 VVT-i (ZZT221_)	95	10/00 02/03
AVENSIS (_T22_)	2.0 D-4D (CDT220_)	81	10/99 02/03
AVENSIS (_T22_)	2.0 TD (CT220_)	66	09/97 02/03
AVENSIS (_T22_)	2.0 VVT-i (AZT220_)	110	10/00 02/03
AVENSIS Estate (_T22_)	1.6 (ZZT220_)	81	07/00 02/03
AVENSIS Estate (_T22_)	1.8 (ZZT221_)	95	10/00 02/03
AVENSIS Estate (_T22_)	2.0 (AZT220_)	110	10/00 02/03
AVENSIS Estate (_T22_)	2.0 D-4D (CDT220_)	81	10/99 02/03
AVENSIS Estate (_T22_)	2.0 TD (CT220_)	66	09/97 02/03

AVENSIS Liftback (_T22_)	1.6 (ZZT220_)	81	10/00 02/03
AVENSIS Liftback (_T22_)	1.8 (ZZT221_)	95	10/00 02/03
AVENSIS Liftback (_T22_)	2.0 (AZT220_)	110	10/00 02/03
AVENSIS Liftback (_T22_)	2.0 D-4D (CDT220_)	81	10/99 02/03
AVENSIS Liftback (_T22_)	2.0 TD (CT220_)	66	09/97 02/03
CELICA Convertible (_T20_)	2.0 GTi (ST202)	129	08/94 08/99
CELICA Convertible (_T20_)	2.0 i 16V (ST202)	125	11/93 08/99
CELICA Coupe (_T20_)	2.0 i 16V (ST202/GT)	129	11/93 11/99
CELICA Coupe (_T20_)	2.0 i 16V (ST202_)	125	04/96 11/99

OE Part number

Compatible OE codes

TOYOTA	4351220590
TOYOTA	4351220600
TOYOTA	4351220601
TOYOTA	4351220630