



BRAKE DISC

09.9264.10

The **09.9264.10** brake disc is synonymous with reliability

The Brembo brake disc is fully interchangeable with an Original Equipment brake disc. The control of the entire production cycle allows Brembo to offer brake discs with outstanding performance levels, reliability, durability and comfort in all conditions of use. All Brembo brake discs are accompanied by the ECE-R90 homologation.

- ✓ OE-equivalent
- ✓ Brembo quality
- ✓ ECE-R90 certificate
- ✓ Safety
- ✓ Fastening screws



Technical specifications

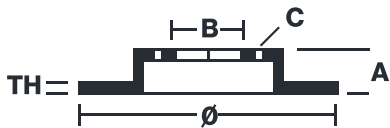

EAN code
8020584926413

Axle
Rear

Diameter Ø
302 mm

Thickness (TH)
22 mm

Height (A)
35 mm

Number of holes (C)
5

Brake disc type
Ventilated

Centering (B)
71 mm

Min. thickness
20 mm

Tightening torque
90 Nm

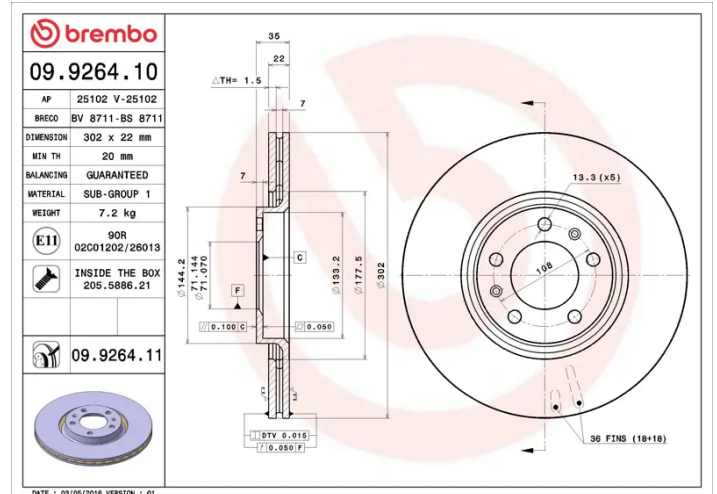

COMPATIBLE VEHICLES

COMPATIBLE OE PART NUMBERS

1618864180	CITROËN
1667857380	CITROËN
424911	CITROËN
9687990780	CITROËN
E169515	CITROËN