

Disc technical data

Axle Front	Diameter 282 mm
Overall height (A) 47,2 mm	Centring diameter (B) 64,2 mm
Number of holes (C) 5	Thickness (TH) 23 mm
Minimum thickness 21 mm	Tightening torque 108 Nm
Unit per box 2	EANCode 8020584018040

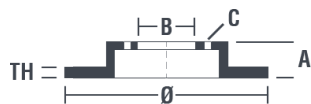

09.A455.14	
AP	25127 V-25127 E
BRECO	BV 8736-BS 8736
DIMENSION	282 x 23 mm
MIN TH	21 mm
BALANCING	GUARANTEED
MATERIAL	SUB-GROUP 1
WEIGHT	6.4 kg
E11	90R 02C01202/25639
	INSIDE THE BOX 205.5886.21
	09.A455.11
DATE : 21/04/2016 VERSION : 02	

Brand part numbers

Brembo 09.A455.14	AP 25127 E	Breco BS 8736
-----------------------------	----------------------	-------------------------

Technical specifications

Disc with fixing screw

By supplying the fixing screw in the disc box, Brembo provides extra help to the mechanic if the original screw is rusty or worn to such an extent as to prevent or make it difficult to reuse.



Compatible vehicles

HONDA			
Model	Type	Kw	Year
CIVIC VIII Hatchback (FN, FK)	1.4 (FK1)	61	09/05 -
CIVIC VIII Hatchback (FN, FK)	1.4 (FK1, FN4)	73	10/08 -
CIVIC VIII Hatchback (FN, FK)	1.6	84	09/05 -
CIVIC VIII Hatchback (FN, FK)	1.8 (FN1, FK2)	103	09/05 -
CIVIC VIII Hatchback (FN, FK)	2.2 CTDi (FK3)	103	09/05 -
CIVIC VIII Saloon (FD, FA)	1.6	84	09/05 -
CIVIC VIII Saloon (FD, FA)	1.8 (FD1, FD7)	103	09/05 02/12
CIVIC VIII Saloon (FD, FA)	1.8 EXS Flex	103	11/06 -

FR-V (BE)	1.7 (BE1)	92	08/04 -
FR-V (BE)	1.8 (BE1)	103	01/07 -
FR-V (BE)	2.0 (BE3)	110	02/05 -
STREAM	1.8 Vtec	103	10/05 -
STREAM	2.0 Vtec	110	10/05 -

OE Part number

Compatible OE codes

HONDA	45251S7AE10
HONDA	45251S7AE11
HONDA	45251SMGE31
HONDA	45251SMGG10
HONDA	45251SMGG11