

Disc 09.A613.40



Disc technical data

Axle Front

Diameter
295 mm

Overall height (A)
64,5 mm

Centring diameter (B)
67 mm

Number of holes (C)
5

Thickness (TH)
28 mm

Minimum thickness
25,4 mm

Tightening torque
130 Nm

Unit per box
2

EANCode
8020584020012

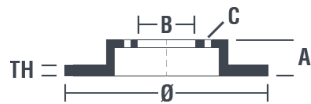

Brand part numbers

Brembo
09.A613.40

AP
25175

Breco
BS 8785

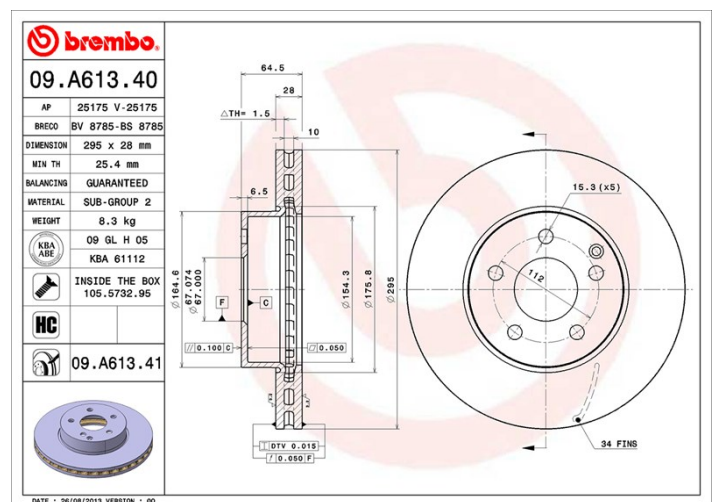

Technical specifications

High Carbon disc (HC)

Thanks to the high percentage of carbon in the chemical composition of the cast iron, the HC disc provides greater damping coefficient, able to reduce vibration and noise while driving.



Disc with fixing screw

By supplying the fixing screw in the disc box, Brembo provides extra help to the mechanic if the original screw is rusty or worn to such an extent as to prevent or make it difficult to reuse.



Compatible vehicles

MERCEDES-BENZ

Model	Type	Kw	Year
C-CLASS (W204)	C 200 (204.048)	137	05/11 01/14
C-CLASS (W204)	C 200 CGI (204.048)	135	01/07 01/14
C-CLASS (W204)	C 200 Kompressor (204.041)	135	01/07 01/14
C-CLASS (W204)	C 220 CDI (204.002)	120	10/08 01/14
C-CLASS (W204)	C 220 CDI (204.002)	125	12/08 01/14
C-CLASS (W204)	C 220 CDI (204.008)	120	01/07 11/08

C-CLASS (W204)	C 220 CDI (204.008)	125	01/07 11/08
C-CLASS (W204)	C 220 CDI 4-matic (204.084)	125	02/13 01/14
C-CLASS (W204)	C 230 (204.052)	150	01/07 01/14
C-CLASS (W204)	C 230 4-matic (204.085)	150	07/07 01/14
C-CLASS (W204)	C 250 CDI (204.003)	150	08/08 01/14
C-CLASS (W204)	C 250 CDI 4-matic (204.082)	150	01/11 01/14
C-CLASS (W204)	C 250 CGI (204.047)	150	07/09 01/14
C-CLASS (W204)	C 280 (204.054)	170	01/07 01/14
C-CLASS (W204)	C 280 4-matic (204.081)	170	07/07 01/14
C-CLASS (W204)	C 300 (204.054)	170	07/09 01/14
C-CLASS (W204)	C 300 4-matic (204.081)	170	07/07 01/14
C-CLASS Coupe (C204)	C 200 CGI (204.348)	135	06/11 -
C-CLASS Coupe (C204)	C 220 CDI (204.302)	120	06/11 -
C-CLASS Coupe (C204)	C 220 CDI (204.302)	125	06/11 -
C-CLASS Coupe (C204)	C 250 (204.347)	150	06/11 -
C-CLASS Coupe (C204)	C 250 CDI (204.303)	150	06/11 -
C-CLASS T-Model (S204)	C 200 CGI (204.248)	135	08/07 08/14
C-CLASS T-Model (S204)	C 200 Kompressor (204.241)	135	08/07 08/14
C-CLASS T-Model (S204)	C 220 CDI (204.202)	120	12/08 08/14
C-CLASS T-Model (S204)	C 220 CDI (204.202)	125	12/08 08/14
C-CLASS T-Model (S204)	C 220 CDI (204.208)	120	08/07 11/08
C-CLASS T-Model (S204)	C 220 CDI (204.208)	125	08/07 11/08
C-CLASS T-Model (S204)	C 220 CDI 4-matic (204.284)	125	02/13 08/14
C-CLASS T-Model (S204)	C 230 (204.252)	150	08/07 08/14
C-CLASS T-Model (S204)	C 250 CDI (204.203)	150	01/09 08/14
C-CLASS T-Model (S204)	C 250 CDI 4-matic (204.282)	150	04/10 08/14
C-CLASS T-Model (S204)	C 250 CGI (204.247)	150	07/09 08/14
C-CLASS T-Model (S204)	C 280 (204.254)	170	08/07 08/14
C-CLASS T-Model (S204)	C 300 (204.254)	170	08/07 08/14
E-CLASS (W212)	E 200 (212.034)	135	01/13 -
E-CLASS (W212)	E 200 CDI / BlueTEC (212.005, 212.006)	100	01/09 -
E-CLASS (W212)	E 200 CGI (212.048, 212.148)	135	08/09 -
E-CLASS (W212)	E 200 NGT (212.035)	115	07/13 -

E-CLASS (W212)	E 200 NGT (212.041)	120	03/11 -
E-CLASS (W212)	E 220 BlueTEC (212.001)	130	05/14 -
E-CLASS (W212)	E 220 CDI	120	01/09 -
E-CLASS (W212)	E 220 CDI / BlueTEC (212.001, 212.002)	125	01/09 -
E-CLASS Convertible (A207)	E 200 CGI (207.448)	135	01/10 -
E-CLASS Convertible (A207)	E 220 BlueTEC (207.401)	130	05/14 -
E-CLASS Convertible (A207)	E 220 CDI (207.402)	120	02/10 -
E-CLASS Convertible (A207)	E 220 CDI / BlueTEC / d (207.402, 207.401)	125	01/10 -
E-CLASS Convertible (A207)	E 250 CGI (207.447)	150	01/10 -
E-CLASS Coupe (C207)	E 200 CGI (207.348)	135	01/10 -
E-CLASS Coupe (C207)	E 220 BlueTEC (207.301)	130	05/14 -
E-CLASS Coupe (C207)	E 220 CDI	120	07/14 -
E-CLASS Coupe (C207)	E 220 CDI / d (207.302, 207.301)	125	01/10 -
E-CLASS Coupe (C207)	E 250 CGI (207.347)	150	01/09 -
E-CLASS T-Model (S212)	E 200 (212.234)	135	11/12 -
E-CLASS T-Model (S212)	E 200 CDI / BlueTEC (212.205, 212.206)	100	11/09 -
E-CLASS T-Model (S212)	E 200 CGI (212.248)	135	11/09 -
E-CLASS T-Model (S212)	E 220 BlueTEC	130	05/15 -
E-CLASS T-Model (S212)	E 220 CDI (212.202)	120	08/09 -
E-CLASS T-Model (S212)	E 220 CDI / BlueTEC (212.202, 212.201)	125	11/09 -
SLC (R172)	180 (172.431)	115	01/16 -
SLK (R172)	200 (172.448)	135	02/11 -
SLK (R172)	250 (172.447)	150	02/11 -

MERCEDES-BENZ (BBDC)

Model	Type	Kw	Year
C-CLASS (W204)	C 200 (204.041)	135	03/08 12/09
C-CLASS (W204)	C 230 (204.052)	150	05/08 10/09
C-CLASS (W204)	C 260 (204.052)	150	01/09 12/10
C-CLASS (W204)	C 260 CGI (204.047)	150	10/09 12/14
C-CLASS (W204)	C 280 (204.054)	170	03/08 01/09
C-CLASS (W204)	C 300 (204.054)	170	05/10 12/11

OE Part number

Compatible OE codes

MERCEDES-BENZ	2044210712
MERCEDES-BENZ	2044211612
MERCEDES-BENZ	2044212412
MERCEDES-BENZ	2044212512
MERCEDES-BENZ	2124211312
MERCEDES-BENZ	A2044210712
MERCEDES-BENZ	A2044211612
MERCEDES-BENZ	A2044212412
MERCEDES-BENZ	A2044212512
MERCEDES-BENZ	A2124211312