



# BRAKE PAD

## P 28 107

**The P 28 107 brake pad is synonymous with reliability**

The Brembo brake pad guarantees ultimate safety when braking thanks to the use of more than 100 different compounds, designed according to the type of vehicle and use. Stopping distances reduced to a minimum, maximum driving comfort and silent operation are the most important features of Brembo materials. Brembo brake pads are supplied together with an extensive range of accessories and assembly kits for professional-standard installation.

- ✓ OE-equivalent
- ✓ Brembo quality
- ✓ ECE-R90 certificate
- ✓ Safety
- ✓ Performance
- ✓ Comfort
- ✓ With accessories

### Technical specifications

EAN code                      Axle                      Thickness  
**8020584117187**              **Rear**                      **17 mm**

Width                      Height  
**117 mm**                      **49 mm**

Wear indicator              Accessories  
**Acoustic**                      **With accessories**  
    **With anti-squeal shim**  
    **With brake caliper bolts**

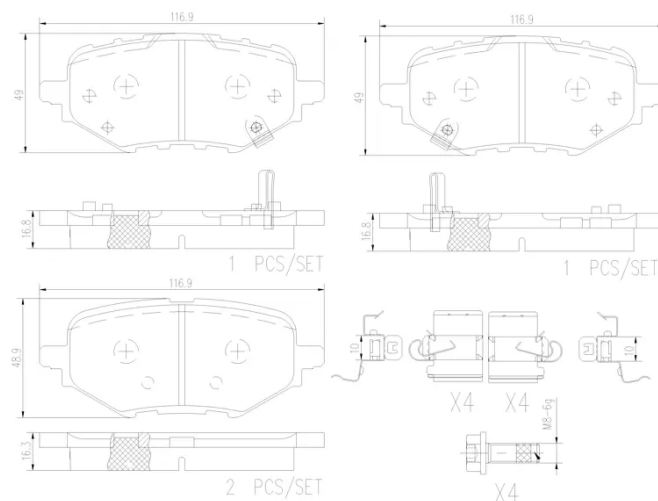

**COMPATIBLE VEHICLES**

# COMPATIBLE OE PART NUMBERS

43022TRTA00	HONDA
43022TRTA10	HONDA
43022TVEH01	HONDA
43022TVEH00	HONDA (DONGFENG)
43022TVEH10	HONDA (DONGFENG)