



# BRAKE DISC

## 09.9817.10

**The 09.9817.10 brake disc is synonymous with reliability**

The Brembo brake disc is fully interchangeable with an Original Equipment brake disc. The control of the entire production cycle allows Brembo to offer brake discs with outstanding performance levels, reliability, durability and comfort in all conditions of use. All Brembo brake discs are accompanied by the ECE-R90 homologation.

- ✓ OE-equivalent
- ✓ Brembo quality
- ✓ ECE-R90 certificate
- ✓ Safety
- ✓ High carbon



### Technical specifications

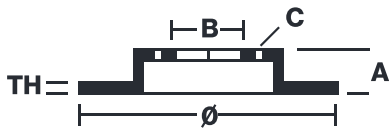

EAN code  
**8020584981719**

Axle  
**Front**

Diameter Ø  
**295 mm**

Thickness (TH)  
**26 mm**

Height (A)  
**49 mm**

Number of holes (C)  
**5**

Brake disc type  
**Ventilated**

Centering (B)  
**55 mm**

Min. thickness  
**24 mm**

Tightening torque  
**103 Nm**

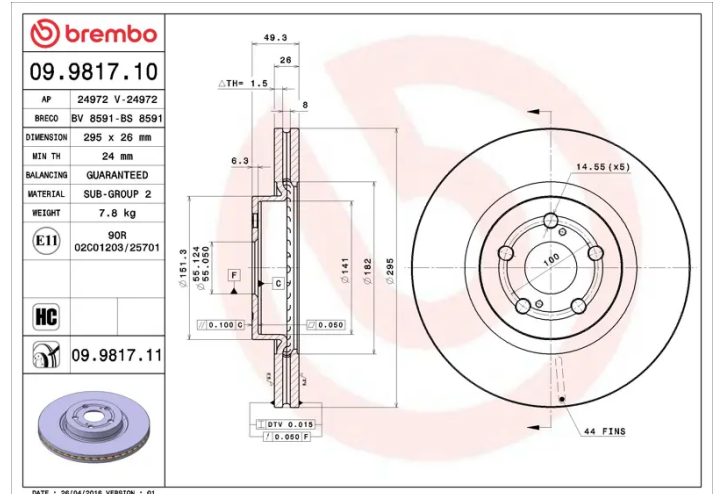

# COMPATIBLE OE PART NUMBERS

4351205050	TOYOTA
4351205070	TOYOTA
4351205110	TOYOTA
43512YZZAB	TOYOTA