



BRAKE DISC

09.B648.10

The **09.B648.10** brake disc is synonymous with reliability

The Brembo brake disc is fully interchangeable with an Original Equipment brake disc. The control of the entire production cycle allows Brembo to offer brake discs with outstanding performance levels, reliability, durability and comfort in all conditions of use. All Brembo brake discs are accompanied by the ECE-R90 homologation.

- ✓ OE-equivalent
- ✓ Brembo quality
- ✓ ECE-R90 certificate
- ✓ Safety
- ✓ Fastening screws



Technical specifications

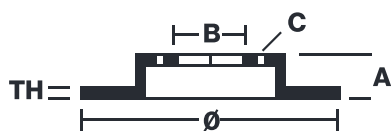

EAN code
8020584036655

Axle
Front

Diameter Ø
296 mm

Thickness (TH)
28 mm

Height (A)
47 mm

Number of holes (C)
5

Brake disc type
Ventilated

Centering (B)
64 mm

Min. thickness
26 mm

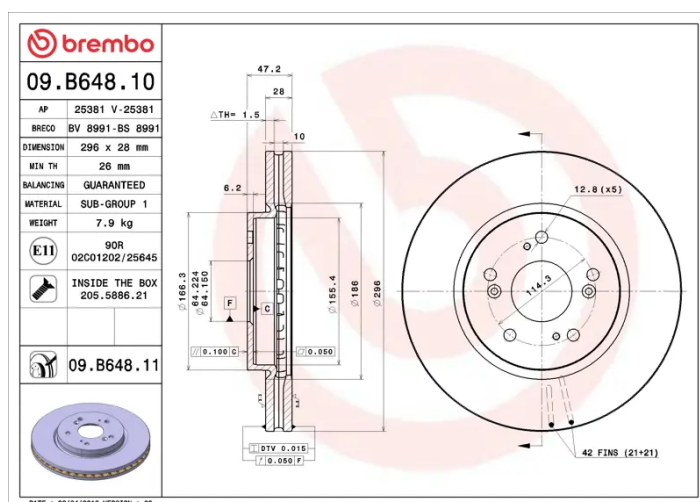

COMPATIBLE VEHICLES

COMPATIBLE OE PART NUMBERS

45251SWAA22	ACURA
45251STKA00	HONDA
45251SWAA21	HONDA
45251SWAA22	HONDA
45251SWE000	HONDA
45251SXSA01	HONDA
45251T0GA00	HONDA
45251SWN020	HONDA (DONGFENG)
45251SWN020	HONDA (GAC)