



BRAKE DISC

09.5264.10

The **09.5264.10** brake disc is synonymous with reliability

The Brembo brake disc is fully interchangeable with an Original Equipment brake disc. The control of the entire production cycle allows Brembo to offer brake discs with outstanding performance levels, reliability, durability and comfort in all conditions of use. All Brembo brake discs are accompanied by the ECE-R90 homologation.

- ✓ OE-equivalent
- ✓ Brembo quality
- ✓ ECE-R90 certificate
- ✓ Safety
- ✓ Fastening screws



Technical specifications

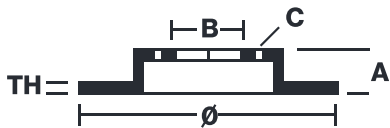

EAN code
8020584526415

Axle
Front

Diameter Ø
276 mm

Thickness (TH)
22 mm

Height (A)
48 mm

Number of holes (C)
5

Brake disc type
Ventilated

Centering (B)
71 mm

Min. thickness
20 mm

Tightening torque
90 Nm

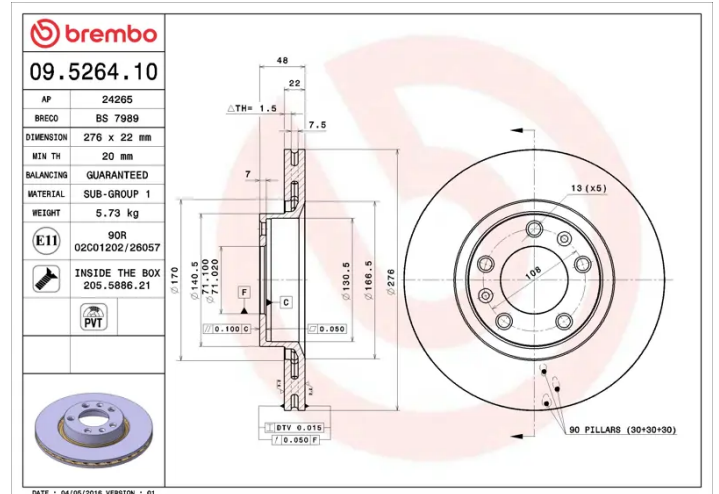

COMPATIBLE VEHICLES

COMPATIBLE OE PART NUMBERS

95637322	CITROËN
95661812	CITROËN
96054779	CITROËN
4246E7	PEUGEOT
4246E8	PEUGEOT
4249C2	PEUGEOT