



# BRAKE DISC

## 09.6851.10

The **09.6851.10** brake disc is synonymous with reliability

The Brembo brake disc is fully interchangeable with an Original Equipment brake disc. The control of the entire production cycle allows Brembo to offer brake discs with outstanding performance levels, reliability, durability and comfort in all conditions of use. All Brembo brake discs are accompanied by the ECE-R90 homologation.

- ✓ OE-equivalent
- ✓ Brembo quality
- ✓ ECE-R90 certificate
- ✓ Safety
- ✓ PVT ventilation



### Technical specifications

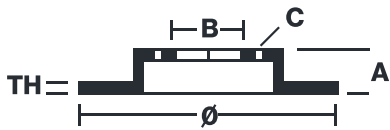

EAN code	Axle	Diameter Ø
<b>8020584685112</b>	<b>Front</b>	<b>255 mm</b>
Thickness (TH)	Height (A)	Number of holes (C)
<b>22,2 mm</b>	<b>72 mm</b>	<b>5</b>
Brake disc type	Centering (B)	Min. thickness
<b>Ventilated</b>	<b>53 mm</b>	<b>20 mm</b>

COMPATIBLE VEHICLES

## COMPATIBLE OE PART NUMBERS

HE013325X	MAZDA
-----------	-------

---

HE013325XB	MAZDA
------------	-------

---

HE013325XC	MAZDA
------------	-------

---

HEQ133251	MAZDA
-----------	-------

---

HF0533251	MAZDA
-----------	-------

---

HF0533251A	MAZDA
------------	-------

---