



CLUTCH CYLINDER E 56 037

The E 56 037 clutch cylinder is synonymous with reliability

Brembo's range of clutch cylinders consists not only of external clutch cylinders but also concentric clutch slave cylinders. The concentric clutch slave cylinder combines the functions of the thrust bearing and of the clutch cylinder in a single part. The clutch is therefore operated directly by the concentric actuator which performs the functions of the clutch cylinder and of the thrust bearing.

- ✓ OE-equivalent
- ✓ Brembo quality
- ✓ Safety
- ✓ Durability
- ✓ Durability test
- ✓ Tightness test

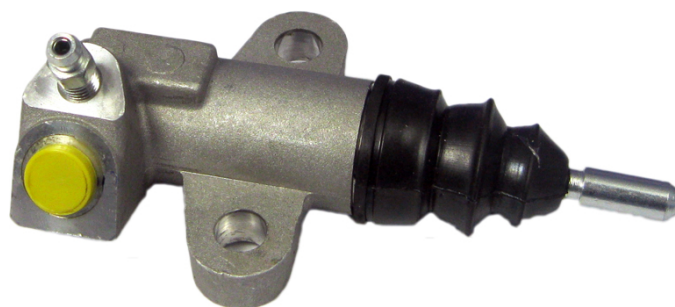

Technical specifications

EAN code	Axle	Diameter
8432509658581		19,05 mm
Threading	Material	
10 x 1	Aluminium	

COMPATIBLE OE PART NUMBERS

306200W00A	NISSAN
306200W020	NISSAN
306200W060	NISSAN