

Caractéristiques techniques du disque

Essieu Arrière

Diamètre
288 mm

Hauteur totale (A)
64,9 mm

Diamètre de centrage (B)
55 mm

Nombre de trous de fixation (C)
5

Épaisseur (TH)
10 mm

Épaisseur min.
8,5 mm

Couple de serrage
103 N.m

Unités par boîte
2

Code EAN
8020584018392

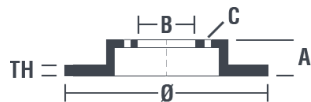

Références marques

Brembo
08.A338.10

AP
14950

Breco
BS 7741

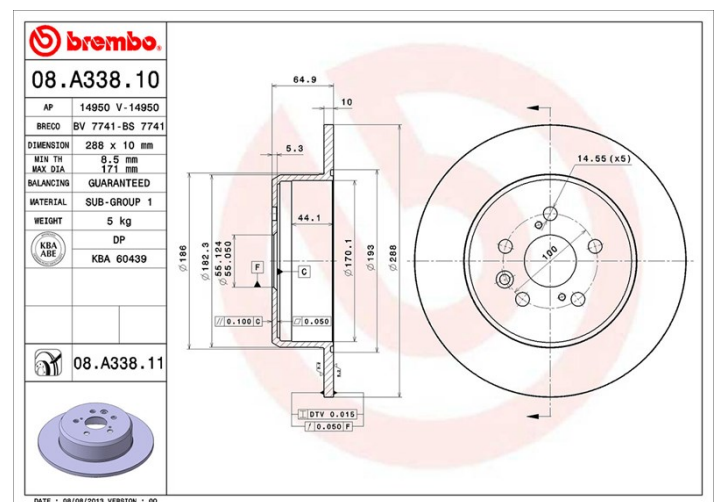

Spécifications techniques

Véhicules couverts

TOYOTA

Modèle	Type	kW	Année
AVENSIS (_T22_)	1.6 (AT220_)	74	09/97 10/00
AVENSIS (_T22_)	1.6 (AT220_)	81	10/97 06/00
AVENSIS (_T22_)	1.6 VVT-i (ZZT220_)	81	10/00 02/03
AVENSIS (_T22_)	1.8 (AT221_)	81	09/97 10/00
AVENSIS (_T22_)	1.8 VVT-i (ZZT221_)	95	10/00 02/03
AVENSIS (_T22_)	2.0 (ST220_)	94	09/97 10/00
AVENSIS (_T22_)	2.0 D (CT220_)	61	10/97 05/98
AVENSIS (_T22_)	2.0 D-4D (CDT220_)	81	10/99 02/03
AVENSIS (_T22_)	2.0 TD (CT220_)	66	09/97 02/03
AVENSIS (_T22_)	2.0 VVT-i (AZT220_)	110	10/00 02/03

AVENSIS Estate (_T22_)	1.6 (AT220_)	74	09/97 10/00
AVENSIS Estate (_T22_)	1.6 (AT220_, ZZT220_)	81	09/97 10/00
AVENSIS Estate (_T22_)	1.6 (ZZT220_)	81	07/00 02/03
AVENSIS Estate (_T22_)	1.8 (AT221_)	81	09/97 10/00
AVENSIS Estate (_T22_)	1.8 (ZZT221_)	95	10/00 02/03
AVENSIS Estate (_T22_)	2.0 (AZT220_)	110	10/00 02/03
AVENSIS Estate (_T22_)	2.0 (ST220_)	94	09/97 10/00
AVENSIS Estate (_T22_)	2.0 D (CT220_)	61	10/97 05/98
AVENSIS Estate (_T22_)	2.0 D-4D (CDT220_)	81	10/99 02/03
AVENSIS Estate (_T22_)	2.0 TD (CT220_)	66	09/97 02/03
AVENSIS Liftback (_T22_)	1.6 (AT220_)	74	09/97 10/00
AVENSIS Liftback (_T22_)	1.6 (AT220_)	81	09/97 10/00
AVENSIS Liftback (_T22_)	1.6 (ZZT220_)	81	10/00 02/03
AVENSIS Liftback (_T22_)	1.8 (AT221_)	81	09/97 10/00
AVENSIS Liftback (_T22_)	1.8 (ZZT221_)	95	10/00 02/03
AVENSIS Liftback (_T22_)	2.0 (AZT220_)	110	10/00 02/03
AVENSIS Liftback (_T22_)	2.0 (ST220_)	94	09/97 10/00
AVENSIS Liftback (_T22_)	2.0 D-4D (CDT220_)	81	10/99 02/03
AVENSIS Liftback (_T22_)	2.0 TD (CT220_)	66	09/97 02/03

Refs constructeur

Références constructeurs compatibles

TOYOTA	4243120430
--------	------------