



# BRAKE PAD

## P 28 092

**The P 28 092 brake pad is synonymous with reliability**

The Brembo brake pad guarantees ultimate safety when braking thanks to the use of more than 100 different compounds, designed according to the type of vehicle and use. Stopping distances reduced to a minimum, maximum driving comfort and silent operation are the most important features of Brembo materials. Brembo brake pads are supplied together with an extensive range of accessories and assembly kits for professional-standard installation.

- ✓ OE-equivalent
- ✓ Brembo quality
- ✓ ECE-R90 certificate
- ✓ Safety
- ✓ Performance
- ✓ Comfort

### Technical specifications

EAN code	Axle	Thickness
<b>8020584117064</b>	<b>Front</b>	<b>15 mm</b>
Width	Height	
<b>104 mm</b>	<b>43 mm</b>	
Wear indicator	Accessories	
<b>Acoustic</b>	<b>With anti-squeal shim</b>	

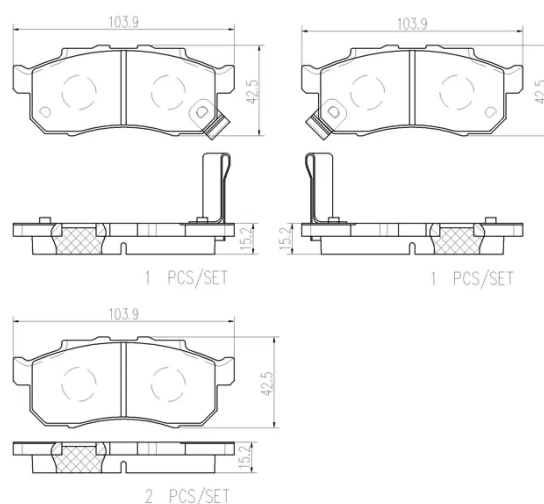

**COMPATIBLE VEHICLES**

# COMPATIBLE OE PART NUMBERS

06450S2KJ00	HONDA
06450S3AJ00	HONDA
06450SFA000	HONDA
45022S2K000	HONDA
45022S3A000	HONDA
45022S3AJ00	HONDA
45022SA7000	HONDA
45022SA7010	HONDA
45022SA7020	HONDA
45022SA7030	HONDA
45022SA7040	HONDA
45022SFA000	HONDA
45022SJ6325	HONDA
45022ST5000	HONDA
45022ST5010	HONDA
45022ST5020	HONDA
45022ST5405	HONDA
45022ST5408	HONDA
45022ST5415	HONDA
45022TY0000	HONDA
H4502S3A003	HONDA
H4502ST5003	HONDA
H4502ST5004	HONDA
AY040KE016	NISSAN
AY040KE130	NISSAN