



BRAKE DISC
09.9743.10

The 09.9743.10 brake disc is synonymous with reliability

The Brembo brake disc is fully interchangeable with an Original Equipment brake disc. The control of the entire production cycle allows Brembo to offer brake discs with outstanding performance levels, reliability, durability and comfort in all conditions of use. All Brembo brake discs are accompanied by the ECE-R90 homologation.



- ✓ OE-equivalent
- ✓ Brembo quality
- ✓ ECE-R90 certificate
- ✓ Safety
- ✓ High carbon

Technical specifications

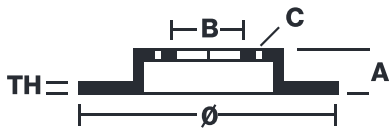

EAN code
8020584974315

Axle
Front

Diameter Ø
302 mm

Thickness (TH)
28 mm

Height (A)
39 mm

Number of holes (C)
5

Brake disc type
Ventilated

Centering (B)
74 mm

Min. thickness
26,5 mm

Tightening torque
129 Nm

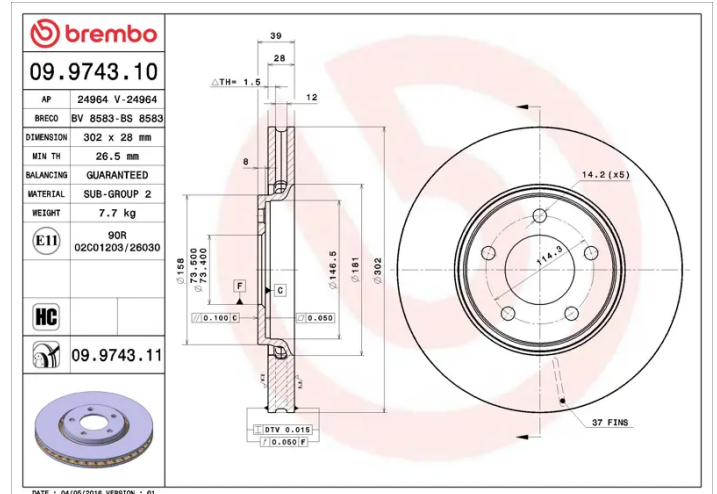

COMPATIBLE OE PART NUMBERS

4683918	CHRYSLER
4683918AA	CHRYSLER
4683918AB	CHRYSLER
4683918AD	CHRYSLER
46833918AB	DODGE