



BRAKE DISC

09.9817.10

The **09.9817.10** brake disc is synonymous with reliability

The Brembo brake disc is fully interchangeable with an Original Equipment brake disc. The control of the entire production cycle allows Brembo to offer brake discs with outstanding performance levels, reliability, durability and comfort in all conditions of use. All Brembo brake discs are accompanied by the ECE-R90 homologation.

- ✓ OE-equivalent
- ✓ Brembo quality
- ✓ ECE-R90 certificate
- ✓ Safety
- ✓ High carbon



Technical specifications

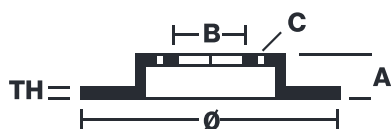

EAN code
8020584981719

Axle
Front

Diameter Ø
295 mm

Thickness (TH)
26 mm

Height (A)
49 mm

Number of holes (C)
5

Brake disc type
Ventilated

Centering (B)
55 mm

Min. thickness
24 mm

Tightening torque
103 Nm

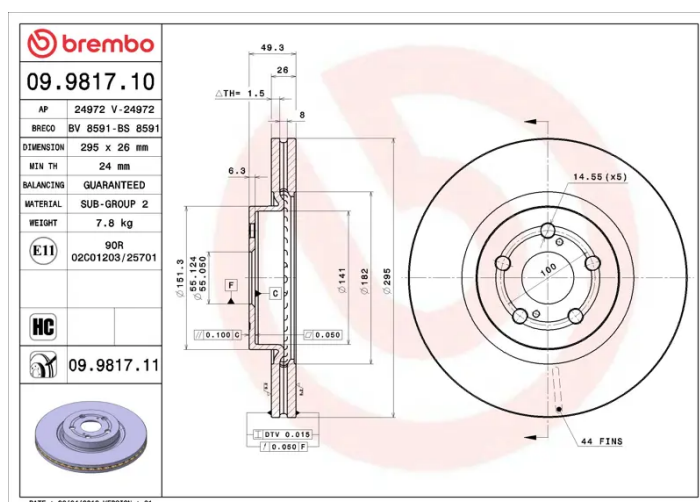

COMPATIBLE VEHICLES

COMPATIBLE OE PART NUMBERS

4351205050	TOYOTA
4351205070	TOYOTA
4351205110	TOYOTA
43512YZZAB	TOYOTA