



# BRAKE PAD

## P 28 027

**The P 28 027 brake pad is synonymous with reliability**

The Brembo brake pad guarantees ultimate safety when braking thanks to the use of more than 100 different compounds, designed according to the type of vehicle and use. Stopping distances reduced to a minimum, maximum driving comfort and silent operation are the most important features of Brembo materials. Brembo brake pads are supplied together with an extensive range of accessories and assembly kits for professional-standard installation.

- ✓ OE-equivalent
- ✓ Brembo quality
- ✓ ECE-R90 certificate
- ✓ Safety
- ✓ Performance
- ✓ Comfort
- ✓ With accessories



### Technical specifications

EAN code	Axle	Thickness
8020584052617	Rear	15 mm
Width	Height	Braking system
85 mm	63 mm	Lucas
Wear indicator	WVA number	Accessories
Acoustic	21682,21683,21684	With accessories With anti-squeal shim With brake caliper bolts

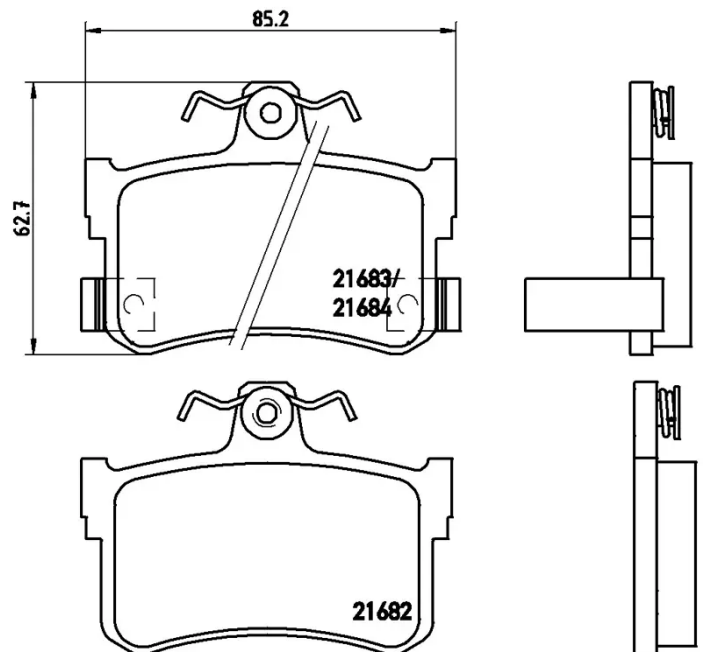

COMPATIBLE VEHICLES

# COMPATIBLE OE PART NUMBERS

SFP000360	MG
GBP90302AF	ROVER
GBP90323	ROVER
GBP90323AF	ROVER
SFP10012	ROVER