



BRAKE DISC

08.5582.10

The **08.5582.10** brake disc is synonymous with reliability

The Brembo brake disc is fully interchangeable with an Original Equipment brake disc. The control of the entire production cycle allows Brembo to offer brake discs with outstanding performance levels, reliability, durability and comfort in all conditions of use. All Brembo brake discs are accompanied by the ECE-R90 homologation.

- ✓ OE-equivalent
- ✓ Brembo quality
- ✓ ECE-R90 certificate
- ✓ Safety
- ✓ Fastening screws



Technical specifications

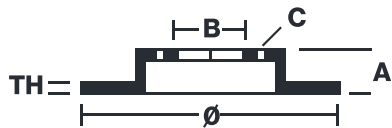

EAN code
8020584558218

Axle
Rear

Diameter Ø
260 mm

Thickness (TH)
10 mm

Height (A)
43 mm

Number of holes (C)
4

Brake disc type
Solid

Centering (B)
64 mm

Min. thickness
8 mm

Tightening torque
110 Nm

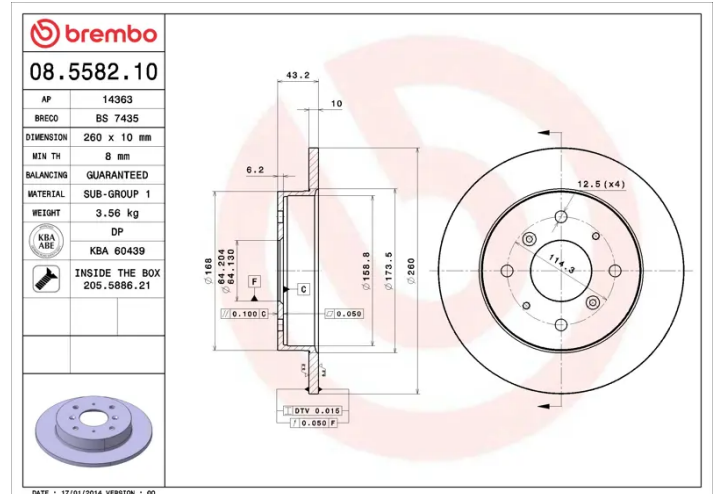

COMPATIBLE VEHICLES

COMPATIBLE OE PART NUMBERS

42510SG9000	ACURA
42510SG9010	ACURA
42510SG9000	HONDA
42510SG9010	HONDA
GBD90834	MG
CLP3758	ROVER
GBD90802	ROVER
SDB090802EVA	ROVER