



# BRAKE DISC

## 08.B357.10

The **08.B357.10** brake disc is synonymous with reliability

The Brembo brake disc is fully interchangeable with an Original Equipment brake disc. The control of the entire production cycle allows Brembo to offer brake discs with outstanding performance levels, reliability, durability and comfort in all conditions of use. All Brembo brake discs are accompanied by the ECE-R90 homologation.

- ✓ OE-equivalent
- ✓ Brembo quality
- ✓ ECE-R90 certificate
- ✓ Safety
- ✓ Fastening screws



### Technical specifications

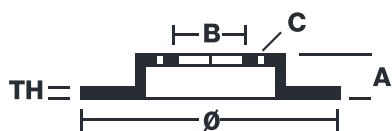

EAN code  
**8020584028421**

Axle  
**Rear**

Diameter  $\varnothing$   
**268 mm**

Thickness (TH)  
**12 mm**

Height (A)  
**45 mm**

Number of holes (C)  
**5**

Brake disc type  
**Solid**

Centering (B)  
**60 mm**

Min. thickness  
**10 mm**

Tightening torque  
**110 Nm**

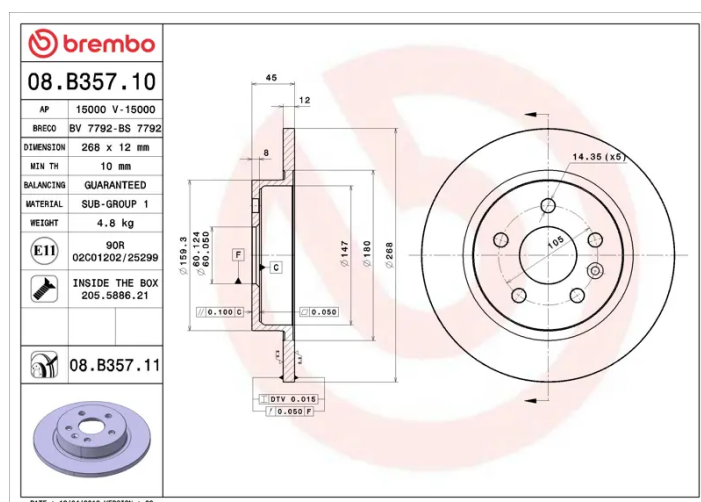

COMPATIBLE VEHICLES

## COMPATIBLE OE PART NUMBERS

13502135	BUICK (SGM)
13502136	BUICK (SGM)
13502134	CHEVROLET
13502135	CHEVROLET
13502136	CHEVROLET
13502864	CHEVROLET
13505759	CHEVROLET
23118283	CHEVROLET
13502135	CHEVROLET (SGM)
13502136	CHEVROLET (SGM)
13502134	OPEL
13502135	OPEL
569072	OPEL
569074	OPEL
95527032	OPEL
13502134	VAUXHALL
13502135	VAUXHALL
95527032	VAUXHALL