



# BRAKE DISC

## 09.B520.10

**The 09.B520.10 brake disc is synonymous with reliability**

The Brembo brake disc is fully interchangeable with an Original Equipment brake disc. The control of the entire production cycle allows Brembo to offer brake discs with outstanding performance levels, reliability, durability and comfort in all conditions of use. All Brembo brake discs are accompanied by the ECE-R90 homologation.

- ✓ OE-equivalent
- ✓ Brembo quality
- ✓ ECE-R90 certificate
- ✓ Safety
- ✓ High carbon

### Technical specifications

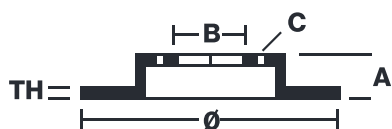

EAN code	Axle	Diameter Ø
<b>8020584230503</b>	<b>Front</b>	<b>275 mm</b>
Thickness (TH)	Height (A)	Number of holes (C)
<b>25 mm</b>	<b>46 mm</b>	<b>5</b>
Brake disc type	Centering (B)	Min. thickness
<b>Ventilated</b>	<b>62 mm</b>	<b>22 mm</b>

COMPATIBLE VEHICLES

### COMPATIBLE OE PART NUMBERS

4351242040	LEXUS
4351242040	TOYOTA
4351242080	TOYOTA