



# BRAKE DISC GT | TY1

## 102.9006A

### The 102.9006A brake disc kit for track day enthusiasts

The GT|D, GT|TY1 and GT|TY3 disc kits provide maximum performance and optimum braking balance while retaining original equipment calipers. These systems are in fact designed to be fully compatible with standard calipers, wheels and all other original equipment components. Depending on the vehicle, the discs can be updated, in which case a dedicated bracket is supplied to allow installation with OE calipers, and the space occupied within the rim must be specified.

- ✓ OE-equivalent
- ✓ Safety
- ✓ Performance
- ✓ Comfort
- ✓ Exclusive style
- ✓ Racing inspired
- ✓ Sports driving
- ✓ Sporty look



### Technical specifications

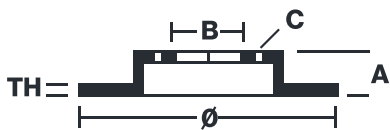

Diameter	Thickness (TH)	Height (A)
<b>380 mm</b>	<b>34 mm</b>	<b>62 mm</b>
Number of holes (C)	Brake disc type	Centering
<b>10</b>	<b>2 pieces</b>	<b>68 mm</b>
Min. thickness	Axle	
<b>33 mm</b>	<b>Front</b>	
Units per box	EAN code	
<b>2</b>	<b>-</b>	

