

Technische gegevens hydraulische rem

As Achter

Diameter (Ø)
288 mm

Totale hoogte (A)
60,4 mm

Diameter centreringen (B)
62 mm

Aantal gaten (C)
5

Dikte (TH)
10 mm

Minimumdikte
8,5 mm

Aanhaalmoment
103 Nm

Aantal per doos
2

EAN-code
8020584018484

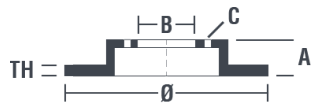

Codes merken

Brembo
08.A150.10

AP
14892

Breco
BS 7707

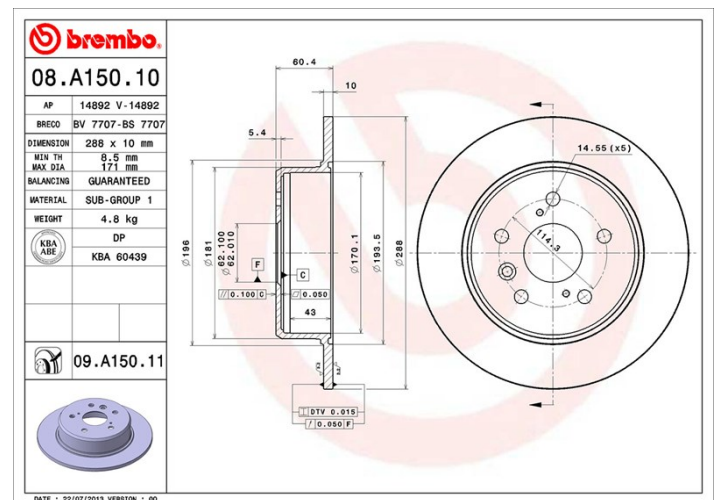

Technische specificaties

Compatibele voertuigen

LEXUS

Model	Type	Kw	Jaar
RX (MCU15)	300 (MCU10_)	148	01/98 02/03
RX (MCU15)	300 AWD	148	10/00 05/03
RX (MCU15)	300 AWD (MCU15_)	164	01/98 02/03

TOYOTA

Model	Type	Kw	Jaar
HARRIER (_U1_)	2.2 4WD	103	03/98 01/03
HARRIER (_U1_)	2.4	118	06/00 01/03
HARRIER (_U1_)	2.4 4WD	118	06/00 01/03
HARRIER (_U1_)	3.0 4WD (MCU15)	164	03/98 01/03

OE-codes

Compatibele OE-codes

LEXUS	4243133080
-------	------------

TOYOTA	4243133080
--------	------------
