

## Technische gegevens hydraulische rem

<b>As</b> Voor	<b>Diameter</b> (∅) 273,5 mm
<b>Totale hoogte</b> (A) 47,5 mm	<b>Diameter centreringen</b> (B) 72 mm
<b>Aantal gaten</b> (C) 5	<b>Dikte</b> (TH) 24 mm
<b>Minimumdikte</b> 22 mm	<b>Aanhaalmoment</b> 103 Nm
<b>Aantal per doos</b> 2	<b>EAN-code</b> 8020584958513

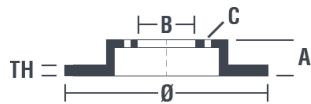

## Codes merken

<b>Brembo</b> 09.9585.14	<b>AP</b> 24935 E	<b>Breco</b> BS 8554
-----------------------------	----------------------	-------------------------

**09.9585.14**

AP	24935 V-24935 E
BRECO	BS 8554-BS 8554
DIMENSION	273.5 x 24 mm
MIN TH	22 mm
BALANCING	GUARANTEED
MATERIAL	SUB-GROUP 1
WEIGHT	6.5 kg
KBA ABE	DA KBA 60436

**09.9585.11**

DATE : 30/09/2013 VERSION : 00

## Technische specificaties

## Compatibele voertuigen

### BESTURN (FAW)

Model	Type	Kw	Jaar
B50	1.4 T	100	07/16 -
B50	1.6	76	05/09 -
B50	1.6	80	09/13 -
B50	1.8	102	09/13 -
B70	2.0	108	01/06 12/12
B70	2.3	120	01/06 12/12
B70	1.8	137	05/14 -
B70	1.8	102	06/12 12/14
B70	2.0	108	05/14 -

### MAZDA

Model	Type	Kw	Jaar
323 F VI (BJ)	2.0	96	01/01 05/04
323 S VI (BJ)	2.0	96	01/01 05/04
6 Hatchback (GG)	1.8	88	08/02 08/07
6 Saloon (GG)	1.8	88	08/02 08/07
6 Station Wagon (GY)	1.8	88	08/02 08/07
626 V Station Wagon (GW)	1.8	74	01/00 10/02
626 V Station Wagon (GW)	2.0	85	02/98 10/02
626 V Station Wagon (GW)	2.0 DITD	66	09/99 10/02
626 V Station Wagon (GW)	2.0 H.P.	100	02/98 10/02
626 V Station Wagon (GW)	2.0 TD	81	10/00 10/02
626 V Station Wagon (GW)	2.0 Turbo DI	74	04/98 10/02
PREMACY (CP)	1.9	74	07/99 03/05
PREMACY (CP)	2.0	96	11/01 03/05
PREMACY (CP)	2.0 TD	74	07/00 03/05

#### MAZDA (FAW)

Model	Type	Kw	Jaar
6	2.0	99	04/03 -
6 Estate	2.3	120	04/03 12/09

## OE-codes

#### Compatibele OE-codes

MAZDA	GF3Y3325X
MAZDA	GF3Y3325XA