

Dane techniczne tarczy

Oś Przód

Średnica (Ø)
248,5 mm

Wysokość całkowita (A)
45,7 mm

Średnica centrowania (B)
66,7 mm

Ilość otworów (C)
4

Grubość (TH)
9,5 mm

Grubość min.
8,6 mm

Moment dokręcania 
Nm

Sztuk w pudełku
2

Referencja EAN
8020584246214

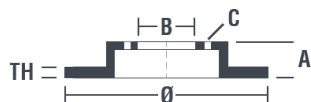

Kody marek

Brembo
08.2462.10

AP
14044

Breco
BS 7119

Specyfikacje techniczne

Pasujące pojazdy

MORRIS			
Model	Typ	kW	Rok
ITAL	1.3	44	07/80 03/84
ITAL	1.7	58	07/80 03/84
ITAL	2.0	67	07/80 03/84
ITAL Station Wagon	1.3	44	07/80 03/84
ITAL Station Wagon	1.7	58	07/80 03/84
ITAL Station Wagon	2.0	67	07/80 03/84
MARINA	1.8	59	04/71 12/79
MARINA	1.8 TC	68	04/71 09/75
MARINA	1300	44	04/71 06/75
MARINA	1500 Diesel	37	04/71 09/75
MARINA	1800	54	03/75 10/78
MARINA	1800 GT	70	03/75 10/78

MARINA	1800 HL	70	03/75 10/78
MARINA Coupe	1300	42	04/71 06/75
MARINA Coupe	1800	53	04/71 12/75
MARINA Coupe	1800 TC	70	04/71 12/75
MARINA II Pickup	1.3	41	11/75 10/80
MARINA II Saloon	1300	42	10/75 09/78
MARINA II Saloon	1500 Diesel	37	10/75 09/78
MARINA II Saloon	1750 (ZA)	58	10/75 09/78
MARINA II Saloon	1800	54	10/75 09/78
MARINA II Saloon	2600 (ZA)	81	10/75 09/78
MARINA II Station Wagon	1300	43	03/78 10/80
MARINA II Station Wagon	1800	57	10/75 10/78
MARINA III	1,3	42	10/78 10/80
MARINA III	1,5 Diesel	37	10/78 10/80
MARINA III	1.7	70	10/78 10/80
MARINA III	1.7	78	10/78 10/80
MARINA III	1.7	58	11/78 06/80
MARINA III Estate	1.3	43	10/78 10/80
MARINA III Estate	1.7	58	11/78 06/80
MARINA Station Wagon	1800	57	04/71 10/75

Numery OE

Pasujące kody OE

MORRIS 21H5137