



DRUM

14.6754.10

The 14.6754.10 drum is synonymous with reliability

Brembo has developed several design solutions for drum brakes which combine multiple materials to reduce the overall weight. The most popular range of lamellar graphite cast iron drums is supplemented by cast iron drums with a steel sprocket flange and aluminium drums, whereby only the inner part of the drum on which the shoes operate are made of lamellar cast iron, namely the brake band. Additionally drums with built-in bearing kit and hub are added to this range.

- ✓ OE-equivalent
- ✓ Brembo quality
- ✓ Safety
- ✓ Durability



Technical specifications

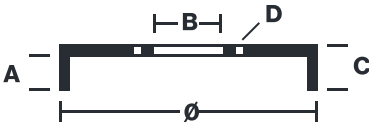

EAN code	Axle	Diameter
8020584675410	Rear	220 mm
Width	Height	Number of holes
44,5 mm	60	4
Centering	Max diameter	
64,1 mm	221 mm	

		14.6754.10	
AP	55195		
BRECO	BT 6754		
DIMENSION	220.1 x 44.5 mm		
MAX DIA	221 mm		
BALANCING	GUARANTEED		
MATERIAL	SUB-GROUP 1		
WEIGHT	5.7 kg		
	90R		
	02D01202/59685		
<small>DATE : 29/06/2021 VERSION : 00</small>			

COMPATIBLE VEHICLES

COMPATIBLE OE PART NUMBERS

42610SM4000	HONDA
42610SM4010	HONDA