

Etriere recondiționate F 61 278



Specificații tehnice etrier recondiționat

Osie Anterioară

Diametru pistoane
60 mm

Număr pistoane
1

Sistem de frânare
ATE

Poziție
Left

Cod EAN
8020584538388

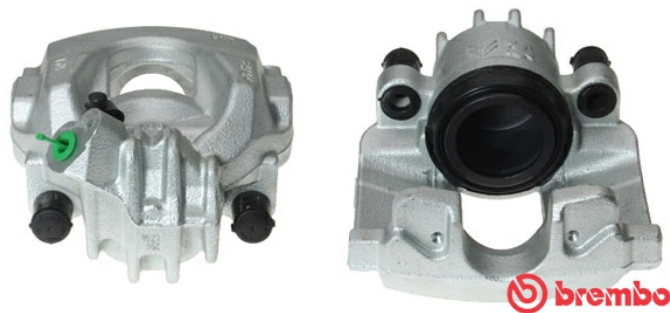

Autovehicule compatibile

CITROËN

Model	Tip	kW	An
C5 III (RD_)	1.6 HDi 115	84	01/12 -
C5 III (RD_)	1.6 THP 150	110	07/10 -
C5 III (RD_)	2.0 HDi 150 / BlueHDi 150	110	04/09 -
C5 III (RD_)	2.0 HDi 165	120	04/09 -
C5 III Break (RW_)	1.6 HDi 115	84	01/12 -
C5 III Break (RW_)	1.6 THP 150	110	04/09 -
C5 III Break (RW_)	1.6 THP 155	115	04/09 -
C5 III Break (RW_)	2.0 HDi 150 / BlueHDi 150	110	04/09 -

PEUGEOT

Model	Tip	kW	An
508 I (8D_)	1.6 HDi	84	02/12 12/18
508 I (8D_)	1.6 HDi	82	11/10 12/18
508 I (8D_)	1.6 THP	115	11/10 12/18
508 I (8D_)	1.6 VTi	88	11/10 12/18
508 I (8D_)	2.0 BlueHDi 150	110	04/14 12/18
508 I (8D_)	2.0 BlueHDi 180	133	04/14 12/18
508 I (8D_)	2.0 HDi	103	11/10 12/18
508 I (8D_)	2.0 HDi	120	11/10 12/18
508 I (8D_)	2.0 HDi Hybrid4 AWC	120	11/10 12/18
508 I (8D_)	2.0 HDi Hybrid4 AWC	147	11/10 12/18

508 I (8D_)	2.2 HDi	150	11/10 12/18
508 II (FB_, FH_, F3_)	2.0 BlueHDi 160 (FHEHYR)	120	10/18 -
508 SW Box Body/Estate (8E_)	1.6 HDi	84	03/13 -
508 SWI (8E_)	1.6 HDi	84	02/12 12/18
508 SWI (8E_)	1.6 HDi	82	11/10 12/18
508 SWI (8E_)	1.6 THP	115	11/10 12/18
508 SWI (8E_)	1.6 VTi	88	11/10 12/18
508 SWI (8E_)	2.0 BlueHDi 150	110	04/14 12/18
508 SWI (8E_)	2.0 BlueHDi 180	133	04/14 12/18
508 SWI (8E_)	2.0 HDi	103	11/10 12/18
508 SWI (8E_)	2.0 HDi	120	11/10 12/18
508 SWI (8E_)	2.2 HDi	150	11/10 12/18

Coduri OE

Coduri OE compatibile

CITROËN	4401 R6
CITROËN	4401R6
PEUGEOT	4401 R6
PEUGEOT	4401R6