



# BRAKE DISC

## 08.5582.10

**The 08.5582.10 brake disc is synonymous with reliability**

The Brembo brake disc is fully interchangeable with an Original Equipment brake disc. The control of the entire production cycle allows Brembo to offer brake discs with outstanding performance levels, reliability, durability and comfort in all conditions of use. All Brembo brake discs are accompanied by the ECE-R90 homologation.

- ✓ OE-equivalent
- ✓ Brembo quality
- ✓ ECE-R90 certificate
- ✓ Safety
- ✓ Fastening screws



### Technical specifications

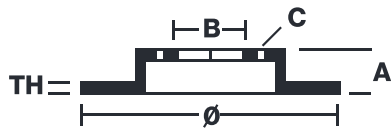

EAN code  
**8020584558218**

Axle  
**Rear**

Diameter Ø  
**260 mm**

Thickness (TH)  
**10 mm**

Height (A)  
**43 mm**

Number of holes (C)  
**4**

Brake disc type  
**Solid**

Centering (B)  
**64 mm**

Min. thickness  
**8 mm**

Tightening torque  
**110 Nm**

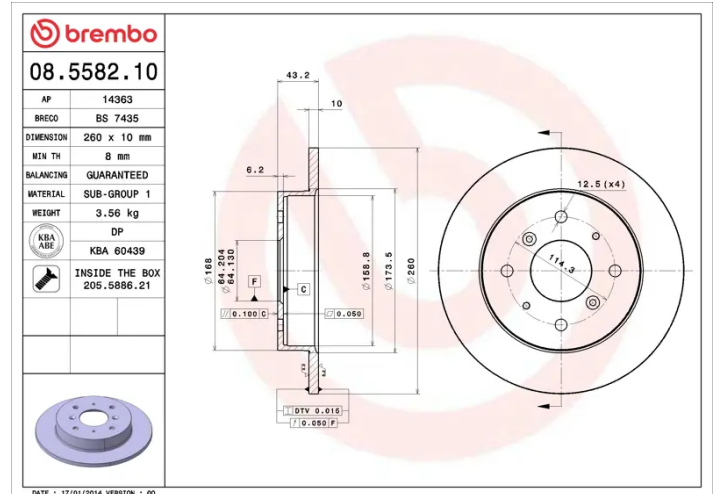

# COMPATIBLE OE PART NUMBERS

42510SG9000	ACURA
42510SG9010	ACURA
42510SG9000	HONDA
42510SG9010	HONDA
GBD90834	MG
CLP3758	ROVER
GBD90802	ROVER
SDB090802EVA	ROVER