



# BRAKE DISC

## 08.A530.10

The **08.A530.10** brake disc is synonymous with reliability

The Brembo brake disc is fully interchangeable with an Original Equipment brake disc. The control of the entire production cycle allows Brembo to offer brake discs with outstanding performance levels, reliability, durability and comfort in all conditions of use. All Brembo brake discs are accompanied by the ECE-R90 homologation.

- ✓ OE-equivalent
- ✓ Brembo quality
- ✓ ECE-R90 certificate
- ✓ Safety



### Technical specifications

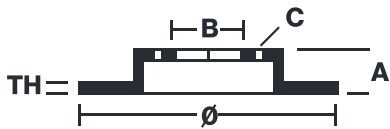

EAN code  
**8020584019344**

Axle  
**Rear**

Diameter Ø  
**280 mm**

Thickness (TH)  
**16 mm**

Height (A)  
**16 mm**

Number of holes (C)  
**5**

Brake disc type  
**Solid**

Centering (B)  
**108 mm**

Min. thickness  
**13 mm**

Tightening torque  
**100 Nm**

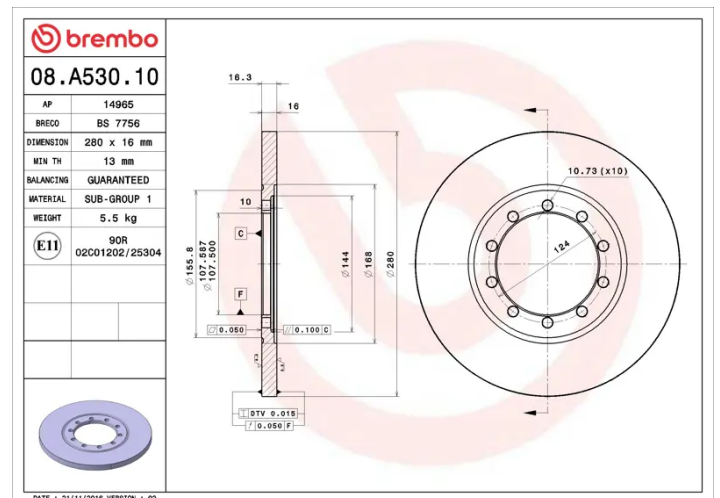

COMPATIBLE VEHICLES

# COMPATIBLE OE PART NUMBERS

1371420	FORD
1464031	FORD
2262937	FORD
6C112A315AB	FORD
ME6C1J2A315AB	FORD
6C112A315AB	FORD (JMC)
6C1Z2C026B	FORD (JMC)
6C1Z2C026E	FORD (JMC)
ME6C1J2A315AB	FORD (JMC)
6C112A315AB	JMC