

## Specificații tehnice disc

**Osie** Anterioară

**Diametru**  
255 mm

**Înălțime totală (A)**  
43,2 mm

**Diametru de centrare (B)**  
55 mm

**Număr orificii (C)**  
4

**Grosime (TH)**  
20 mm

**Grosime min.**  
18 mm

**Cuplu de strângere**   
103 Nm

**Unități per cutie**  
2

**Cod EAN**  
8020584210543

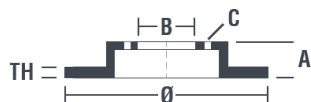

## Coduri mărci

**Brembo**  
09.8545.11

**AP**  
24785 V

**Breco**  
BV 8412

<b>09.8545.10</b>	
AP	24785 V-24785
BRECO	BV 8412-BS 8412
DIMENSION	255 x 20 mm
MIN TH	18 mm
BALANCING	GUARANTEED
MATERIAL	SUB-GROUP 1
WEIGHT	4.7 kg
	09 GL H 05 KBA 61112
<b>09.8545.11</b>	
DATE : 21/11/2014 VERSION : 01	

## Specificații tehnice

### Disc UV

Procesul de vopsire UV garantează o rezistență superioară la coroziune și o protecție completă a discului.



## Autovehicule compatibile

### ENGLON

Model	Tip	kW	An
JINYING	1.5	69	07/08 12/12
JINYING	1.5	75	08/11 12/14
KINGKONG	1.5	78	01/14 -
KINGKONG	1.5	69	05/06 12/13
KINGKONG	1.5	75	05/09 12/13
KINGKONG	1.5 CNG	69	01/09 01/12
KINGKONG	1.6	78	05/06 12/08
KINGKONG	1.8	80	05/07 12/08

KINGKONG CROSS Hatchback	1.5	75	04/14 -
KINGKONG Hatchback	1.5	75	04/14 -
KINGKONG Saloon	1.5	75	04/14 -
<b>FAW (TIANJIN)</b>			
Model	Tip	kW	An
VELA	1.3	63	03/04 12/06
VELA	1.5	75	01/07 12/13
VELA	1.5	66	07/02 12/10
VIZI	1.0	51	07/02 12/06
VIZI	1.3	63	01/03 12/09
VIZI	1.3	68	10/07 01/12
WEIZHI Hatchback	1.3	68	01/07 12/10
WEIZHI Hatchback	1.4	65	01/07 04/18
WEIZHI Hatchback	1.5	75	01/07 12/14
WEIZHI Saloon	1.5	75	01/07 01/15
WEIZHI Saloon	1.5 CNG	75	01/07 01/15
WEIZHI Saloon	1.6	68	01/07 01/08
<b>GEELY</b>			
Model	Tip	kW	An
KINGKONG	1.3	63	05/06 -
KINGKONG	1.5	69	05/06 -
KINGKONG	1.6	79	05/06 -
KINGKONG	1.8	83	05/06 -
KINGKONG	1.8	101	06/05 -
<b>TOYOTA</b>			
Model	Tip	kW	An
MR 2 III (ZZW3_)	1.8 16V VT-i (ZZW30)	103	10/99 06/07
YARIS (_P1_)	1.0 (SCP10_)	48	03/03 09/05
YARIS (_P1_)	1.0 (SCP10_)	50	04/99 09/05
YARIS (_P1_)	1.3 (NCP10_, SCP12_)	63	11/99 10/05
YARIS (_P1_)	1.3 (SCP12_, NCP10_, SCP13_)	64	04/02 09/05
YARIS (_P1_)	1.4 D-4D (NLP10_)	55	10/01 09/05
YARIS (_P1_)	1.5 (NCP13_)	77	01/03 11/05

YARIS (_P1_)	1.5 (NCP13_)	110	03/00 07/05
YARIS (_P1_)	1.5 (NCP13_)	78	04/01 09/05
YARIS VERSO (_P2_)	1.3 (NCP20_, NCP22_)	63	08/99 10/02
YARIS VERSO (_P2_)	1.3 (NCP20_, NCP22_)	62	11/02 09/05
YARIS VERSO (_P2_)	1.4 D-4D (NLP20_, NLP22_)	55	09/00 09/05
YARIS VERSO (_P2_)	1.5 (NCP21_)	77	03/00 09/05
YARIS VERSO (_P2_)	1.5 (NCP21_)	78	03/00 09/05
YARIS VERSO (_P2_)	1.5 4WD (NCP21_)	78	03/00 09/05

## TOYOTA (FAW)

Model	Tip	kW	An
VIOS (P40)	1.3 (AXP41)	64	11/02 10/05
VIOS (P40)	1.5 (AXP42)	68	11/02 02/08

## Coduri OE

### Coduri OE compatibile

TOYOTA	435120D030
TOYOTA	435120D050
TOYOTA	4351217120
TOYOTA	4351217130
TOYOTA	4351217131
TOYOTA	4351252040
TOYOTA	4351252090