



# BRAKE DISC DUAL CAST

## 09.C128.33

**Dual Cast brake disc 09.C128.33 belongs to Brembo Premium Line**

The Dual Cast brake disc is an exclusive Brembo solution characterised by a cast iron braking surface and the aluminium hat, which combine the advantages of cast iron behaviour at high temperatures with the light weight of aluminium. This results in a lighter weight and less thermal deformation for improved braking system performance.

- ✓ OE-equivalent
- ✓ Brembo quality
- ✓ ECE-R90 certificate
- ✓ Weight reduction
- ✓ High carbon
- ✓ Bi-Material Brake Disc
- ✓ Anti-corrosion
- ✓ Fading resistance



### Technical specifications

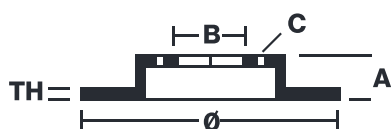

EAN code  
**8020584316368**

Axle  
**Rear**

Diameter Ø  
**360 mm**

Thickness (TH)  
**26 mm**

Height (A)  
**50,5 mm**

Number of holes (C)  
**5**

Brake disc type  
**Ventilated**

Centering (B)  
**67 mm**

Min. thickness  
**24 mm**

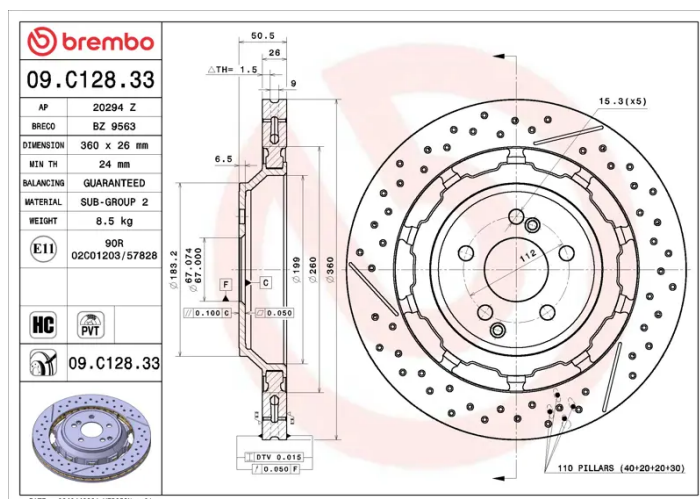

**COMPATIBLE VEHICLES**

# COMPATIBLE OE PART NUMBERS

2224232012	MERCEDES-BENZ
A2224232012	MERCEDES-BENZ