

BRAKE DISC PAINTED 09.D770.11

The 09.D770.11 painted brake disc is synonymous with reliability

The Brembo brake disc with special UV paint treatment guarantees superior corrosion resistance for the product, thanks to the protective coating on the outer edges and on the disc hub. The UV paint not only gives the disc a clean, shiny appearance but is also beneficial for the environment as the water-based UV paint treatment does not require the use of chemical solvents and is a low energy consumption process.



- ✓ OE-equivalent
- ✓ Brembo quality
- ✓ ECE-R90 certificate
- ✓ Safety
- ✓ High carbon
- ✓ Anti-corrosion
- ✓ Fastening screws

Technical specifications

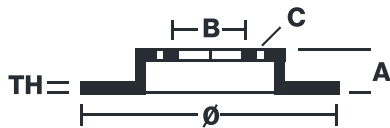

EAN code	Diameter	
8020584313169	330 mm	
Thickness (TH)	Height (A)	Number of holes (C)
30 mm	51 mm	5
Brake disc type	Centering (B)	Min. thickness
Ventilated	67 mm	27,4 mm
Units per box		
1		

COMPATIBLE VEHICLES

MERCEDES-BENZ

A-CLASS (W177)	A 250 (177.046)	165/224	03/18
A-CLASS (W177)	A 250 4-matic (177.047)	165/224	07/18
A-CLASS (W177)	A 250 e (177.086)	118/160	08/19
A-CLASS (W177)	A 250 e (177.086)	160/218	08/19

A-CLASS Saloon (V177)	A 250 (177.146)	165/224	09/18
A-CLASS Saloon (V177)	A 250 4-matic (177.147)	165/224	09/18
A-CLASS Saloon (V177)	A 250 e (177.186)	118/160	08/19
A-CLASS Saloon (V177)	A 250 e (177.186)	160/218	08/19
B-CLASS Sports Tourer (W247)	B 250 (247.046)	165/224	01/19
B-CLASS Sports Tourer (W247)	B 250 4-matic (247.047)	165/224	01/19
B-CLASS Sports Tourer (W247)	B 250 e (247.086)	118/160	06/20
B-CLASS Sports Tourer (W247)	B 250 e (247.086)	160/218	06/20
CLA (C118)	CLA 200 4-matic (118.388)	120/163	10/20
CLA (C118)	CLA 220 (118.344)	140/190	03/19
CLA (C118)	CLA 250 (118.346)	165/224	03/19
CLA (C118)	CLA 250 4-matic (118.347)	165/224	03/19
CLA (C118)	CLA 250 e (118.386)	118/160	06/20
CLA (C118)	CLA 250 e (118.386)	160/218	06/20
CLA Shooting Brake (X118)	CLA 220 (118.644)	140/190	06/19
CLA Shooting Brake (X118)	CLA 250 (118.646)	165/224	06/19
CLA Shooting Brake (X118)	CLA 250 4-matic (118.647)	165/224	06/19
CLA Shooting Brake (X118)	CLA 250 e (118.686)	118/160	06/20
CLA Shooting Brake (X118)	CLA 250 e (118.686)	160/218	06/20
EQA (H243)	EQA 250 (243.701)	140/190	02/21
EQA (H243)	EQA 300 4-matic (243.708, 243.709)	168/228	05/21
EQA (H243)	EQA 350 4-matic (243.712)	215/292	05/21
EQB (X243)	EQB 300 4-matic (243.608, 243.609)	168/228	12/21
EQB (X243)	EQB 350 4-matic (243.612, 243.613)	215/292	12/21
GLA (H247)	GLA 220 d (247.714)	140/190	02/20
GLA (H247)	GLA 220 d 4-matic (247.715)	140/190	02/20
GLA (H247)	GLA 250 (247.746)	165/224	02/20
GLA (H247)	GLA 250 4-matic (247.747)	165/224	02/20
GLA (H247)	GLA 250 e (247.786)	118/160	06/20
GLA (H247)	GLA 250 e (247.786)	160/218	06/20
GLB (X247)	GLB 180 d (247.610)	85/116	08/19
GLB (X247)	GLB 200 (247.687)	120/163	08/19
GLB (X247)	GLB 200 d (247.612)	110/150	08/19
GLB (X247)	GLB 200 d 4-matic (247.613)	110/150	08/19
GLB (X247)	GLB 220 d (247.614)	140/190	12/19
GLB (X247)	GLB 220 d 4-matic (247.615)	140/190	08/19
GLB (X247)	GLB 250 (247.646)	165/224	12/19
GLB (X247)	GLB 250 4-matic (247.647)	165/224	08/19

MERCEDES-BENZ (BBDC)

A-CLASS (W177)	AMG A 35 L 4-matic (177.951)	225/306	11/19
EQA (H243)	EQA 300 4-matic (243.709)	168/228	11/21
EQB (X243)	EQB 350 4-matic (243.613)	215/292	11/21

COMPATIBLE OE PART NUMBERS

2474211912 MERCEDES-BENZ

A2474211912 MERCEDES-BENZ