



# BRAKE PAD

## P 23 201

**The P 23 201 brake pad is synonymous with reliability**

The Brembo brake pad guarantees ultimate safety when braking thanks to the use of more than 100 different compounds, designed according to the type of vehicle and use. Stopping distances reduced to a minimum, maximum driving comfort and silent operation are the most important features of Brembo materials. Brembo brake pads are supplied together with an extensive range of accessories and assembly kits for professional-standard installation.

- ✓ OE-equivalent
- ✓ Brembo quality
- ✓ ECE-R90 certificate
- ✓ Safety
- ✓ Performance
- ✓ Comfort
- ✓ With accessories



### Technical specifications

EAN code	Axle	Thickness
<b>8020584125878</b>	<b>Rear</b>	<b>10 mm</b>
Width	Height	
<b>56 mm</b>	<b>66 mm</b>	
Wear indicator	Accessories	
Without	<b>With accessories</b>	
	<b>With anti-squeal shim</b>	
	<b>With piston clip</b>	

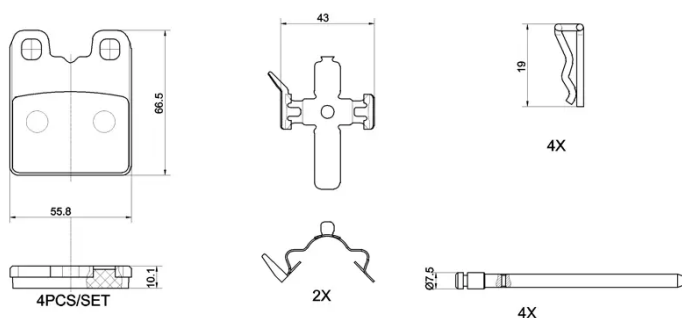

**COMPATIBLE VEHICLES**

# COMPATIBLE OE PART NUMBERS

68367293AA	ALFA ROMEO
77367680	ALFA ROMEO
77368182	ALFA ROMEO
77369156	ALFA ROMEO
84935101	CHEVROLET
84935102	CHEVROLET
673007248	MASERATI