



BRAKE DISC

08.5741.20

The **08.5741.20** brake disc is synonymous with reliability

The Brembo brake disc is fully interchangeable with an Original Equipment brake disc. The control of the entire production cycle allows Brembo to offer brake discs with outstanding performance levels, reliability, durability and comfort in all conditions of use. All Brembo brake discs are accompanied by the ECE-R90 homologation.

- ✓ OE-equivalent
- ✓ Brembo quality
- ✓ ECE-R90 certificate
- ✓ Safety



Technical specifications

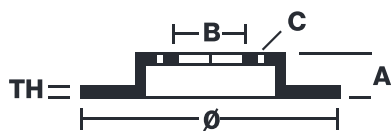

EAN code
8020584574126

Axle
Front

Diameter Ø
219 mm

Thickness (TH)
13 mm

Height (A)
37 mm

Number of holes (C)
4

Brake disc type
Solid

Centering (B)
75 mm

Min. thickness
11 mm

Tightening torque
98 Nm

08.5741.20	
AP	14810
BRECO	BS 7609
DIMENSION	219 x 13 mm
MIN TH	11 mm
BALANCING	GUARANTEED
MATERIAL	SUB-GROUP 1
WEIGHT	3 kg
E11	90R 02001202/25288

DATE : 11/04/2016 VERSION : 01

COMPATIBLE VEHICLES

COMPATIBLE OE PART NUMBERS

KK15033251	KIA
MDA0133251	KIA