



# BRAKE DISC

## 09.3090.10

**The 09.3090.10 brake disc is synonymous with reliability**

The Brembo brake disc is fully interchangeable with an Original Equipment brake disc. The control of the entire production cycle allows Brembo to offer brake discs with outstanding performance levels, reliability, durability and comfort in all conditions of use. All Brembo brake discs are accompanied by the ECE-R90 homologation.

- ✓ OE-equivalent
- ✓ Brembo quality
- ✓ ECE-R90 certificate
- ✓ Safety
- ✓ Fastening screws

### Technical specifications

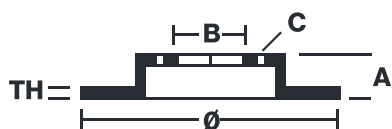

EAN code	Axle	Diameter Ø
-	<b>Front</b>	<b>236 mm</b>
Thickness (TH)	Height (A)	Number of holes (C)
<b>20 mm</b>	<b>41 mm</b>	<b>4</b>
Brake disc type	Centering (B)	Min. thickness
<b>Ventilated</b>	<b>60 mm</b>	<b>17 mm</b>
Tightening torque		
<b>120 Nm</b>		

**COMPATIBLE VEHICLES**

# COMPATIBLE OE PART NUMBERS

96215669	CHEVROLET
90121445	DAEWOO
96215669	DAEWOO
90121445	PONTIAC