



# BRAKE DISC

## 08.6837.10

The **08.6837.10** brake disc is synonymous with reliability

The Brembo brake disc is fully interchangeable with an Original Equipment brake disc. The control of the entire production cycle allows Brembo to offer brake discs with outstanding performance levels, reliability, durability and comfort in all conditions of use. All Brembo brake discs are accompanied by the ECE-R90 homologation.

- ✓ OE-equivalent
- ✓ Brembo quality
- ✓ ECE-R90 certificate
- ✓ Safety



### Technical specifications

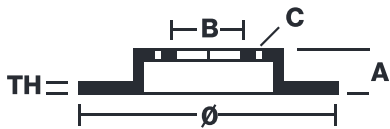

EAN code	Axle	Diameter Ø
<b>8020584683712</b>	<b>Rear</b>	<b>239</b> mm
Thickness (TH)	Height (A)	Number of holes (C)
<b>10</b> mm	<b>33</b> mm	<b>4</b>
Brake disc type	Centering (B)	Min. thickness
<b>Solid</b>	<b>48</b> mm	<b>8</b> mm

## COMPATIBLE OE PART NUMBERS

42510SD2930	ACURA
-------------	-------

42510SD2A00	ACURA
-------------	-------

42510SH3000	ACURA
-------------	-------

42510SK7000	ACURA
-------------	-------

42510SK7A00	ACURA
-------------	-------

42510SD2930	HONDA
-------------	-------

42510SD2A00	HONDA
-------------	-------

42510SH3000	HONDA
-------------	-------

42510SK7000	HONDA
-------------	-------

42510SK7A00	HONDA
-------------	-------