

# BENDIX S5 TYPE Mounting

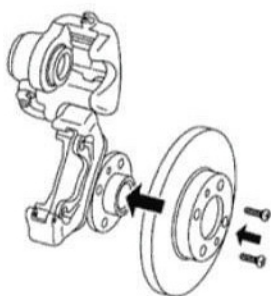

**7**  
Fit the disc on the wheel hub.

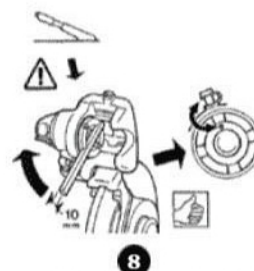

**8**  
Push the piston back. On models with a handbrake screw in the piston and align the fresh air bore hole in front of the bleed screw.

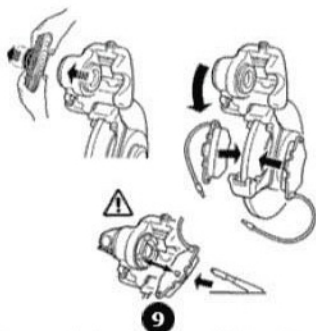

**9**  
Assemble the pads complete with special tooth on the piston side.

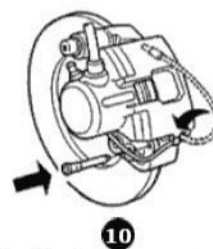

**10**  
Reassemble the pin. Replace the wear sensor in its runner.

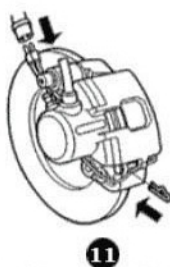

**11**  
Replace the clip on the pad pin.

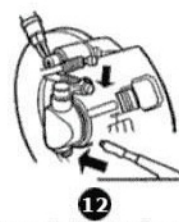

**12**  
Reconnect the brake cable.

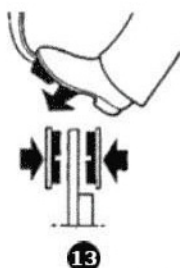

**13**  
Depress the brake pedal several times to bring the pads together.

# BENDIX S5 TYPE Dismounting

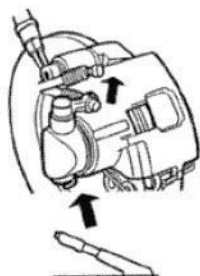

1

Disconnect the handbrake cable, if necessary.

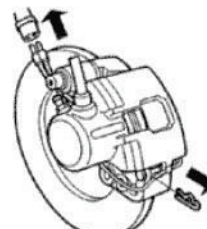

2

Disconnect the wear sensors.

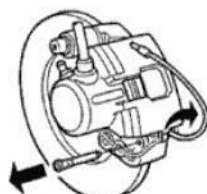

3

Remove the pin. Disconnect the wear sensor from its runner.

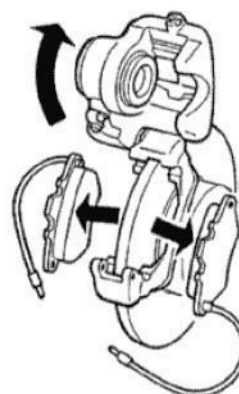

4

Turn the caliper upwards and remove the pads.

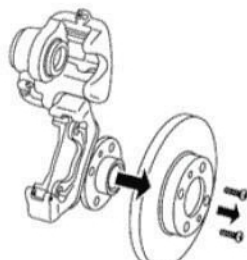

5

Remove the disc.

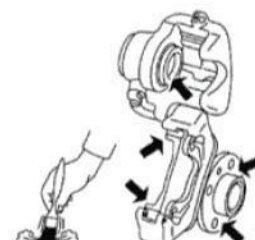

6

Dry clean the caliper and the wheel hub.